



# Installation Instructions

## G-Series Multiple Load Handler Inner Fork Carrier Service Kits

This sheet describes replacing G-Series Multiple Load Handler inner fork carriers with current production inner fork carriers. Inner Carrier Kits:

Type of Carrier	RH Inner Carrier Kit Part No.	LH Inner Carrier Kit Part No.
Standard	6162443	6162444
IFC (Inner Fork Control) Tab	6162436	6162437

These service kits update units with Type 1 and 2 Wear Pads to the latest Type 3 configuration.

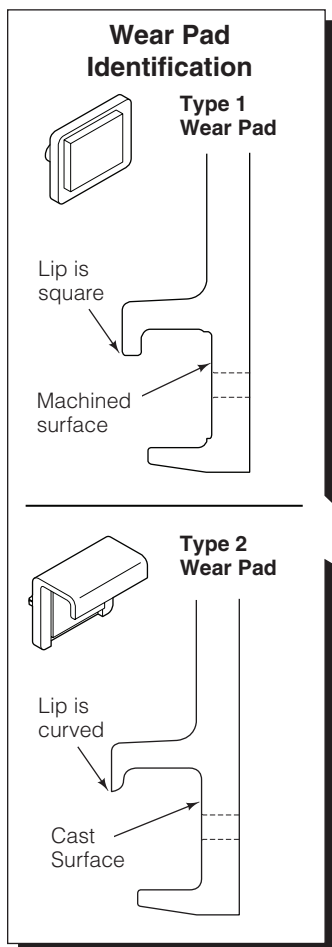

SD0968.eps

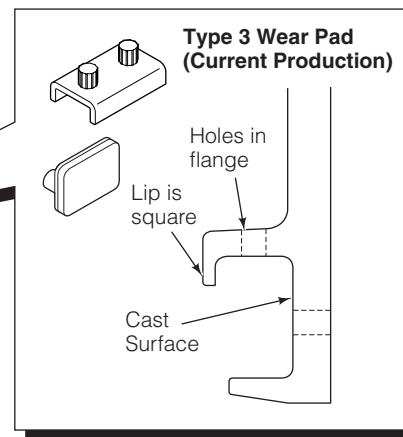
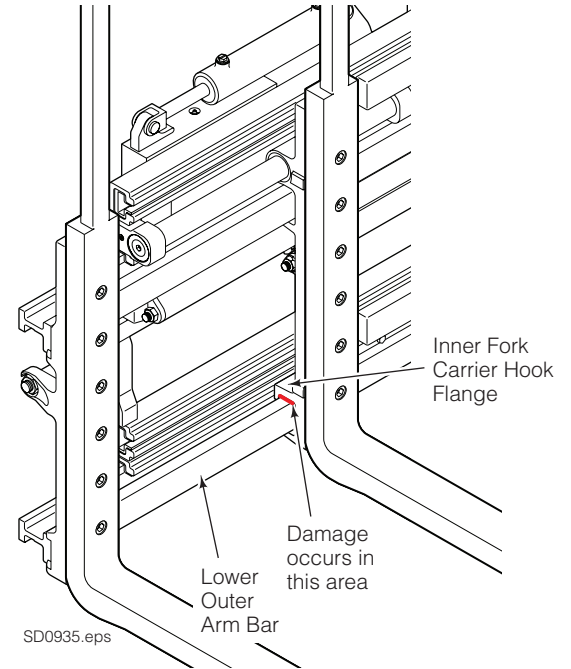

SD1039.eps

**cascade**<sup>®</sup>  
**corporation**

**For Technical Support . . .**

Call: 1-800-227-2233 Fax: 1-888-329-8207  
Internet: [www.cascorp.com](http://www.cascorp.com)  
Write: Cascade Corporation, PO Box 20187, Portland, OR 97294

**To Order Parts . . .**

Call: 1-888-227-2233 Fax: 1-888-329-0234  
Internet: [www.cascorp.com](http://www.cascorp.com)  
Write: Cascade Corporation, 2501 Sheridan Ave., Springfield, OH 45505

# Inner Fork Carrier Replacement

**NOTE:** This service can be performed with the attachment on the truck

- 1 Position forks about .5 in. (12 mm) off the floor. Fully close forks.



**WARNING:** Do not remove the spring cylinder rod end nut when the forks are completely open.

- 2 Open outer forks about 12 in. (300 mm) to access the inner fork carrier. The inner forks should not move.
- 3 Remove the spring cylinder rod end nut from the inner fork carrier. Support the fork spring cylinder with a cable tie. For reassembly, tighten the nut to 37 ft.-lbs. (50 N·m).

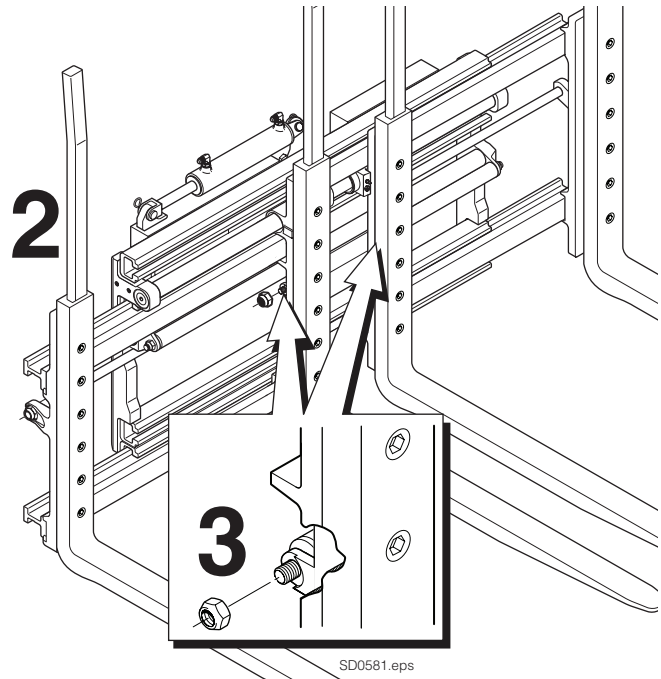

- 4 Remove the bolt-on stops from the outer fork arms, using a modified 6 mm allen wrench (Cascade Part No. 6153293). For reassembly, tighten the socket screws to a torque of 24 ft.-lbs. (32 N·m).

**NOTE:** To remove the upper outer fork carrier fork stop, place a 11 in. long, 2 in. x 6 in. board between the forks (for standard ranges). Close the forks. Remove the stop capscrews.

**IMPORTANT:** Some attachments have different ranges than the standard and the board length will not match the stops to be accessible. Adjust the range of the outer forks and position for accessibility.

- 5 Extend the outer forks outside the width of the frame. Position the forks .5 in (12 mm) above the floor.

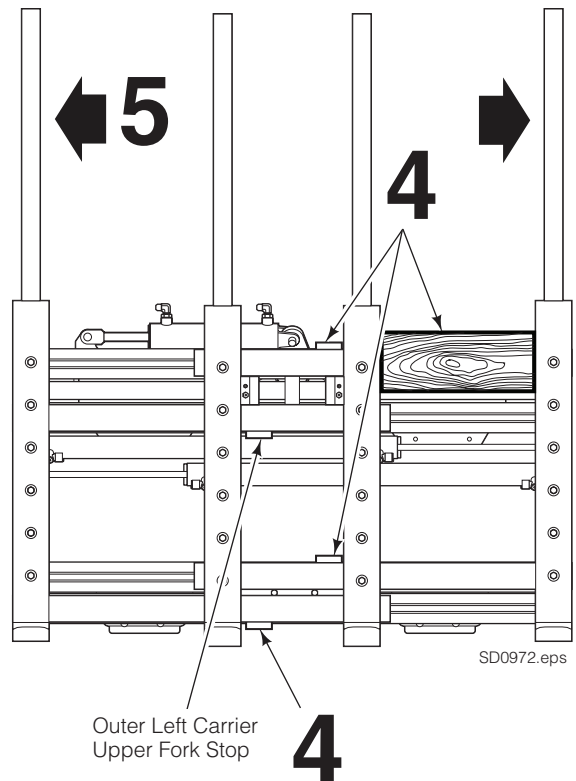

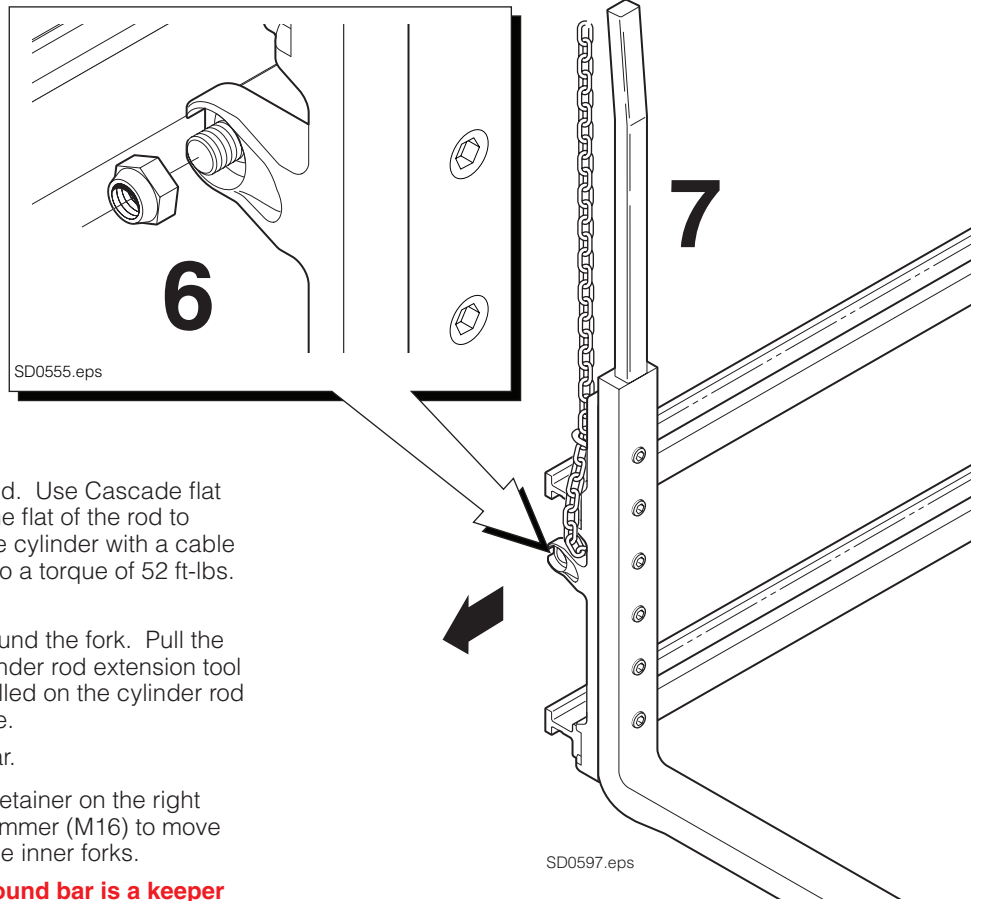

**6** Remove nut from the cylinder rod end. Use Cascade flat wrench, part number 6153275, on the flat of the rod to ease removal of the nut. Support the cylinder with a cable tie. For reassembly, tighten the nut to a torque of 52 ft-lbs. (70 N·m).

**7** Attach a suitable overhead hoist around the fork. Pull the fork assembly out of the frame. Cylinder rod extension tool (part number 6151448) can be installed on the cylinder rod to help push the arm out of the frame.

**CAUTION:** Inspect arm bars for wear.

**8** Remove the capscrew from the pin retainer on the right hand side of the bar. Use a slide hammer (M16) to move the round bar to the left to remove the inner forks.

**CAUTION:** On the left end of the round bar is a keeper pin. Failure to remove the round bar out the left side can damage the grease seals on the inner fork carrier.

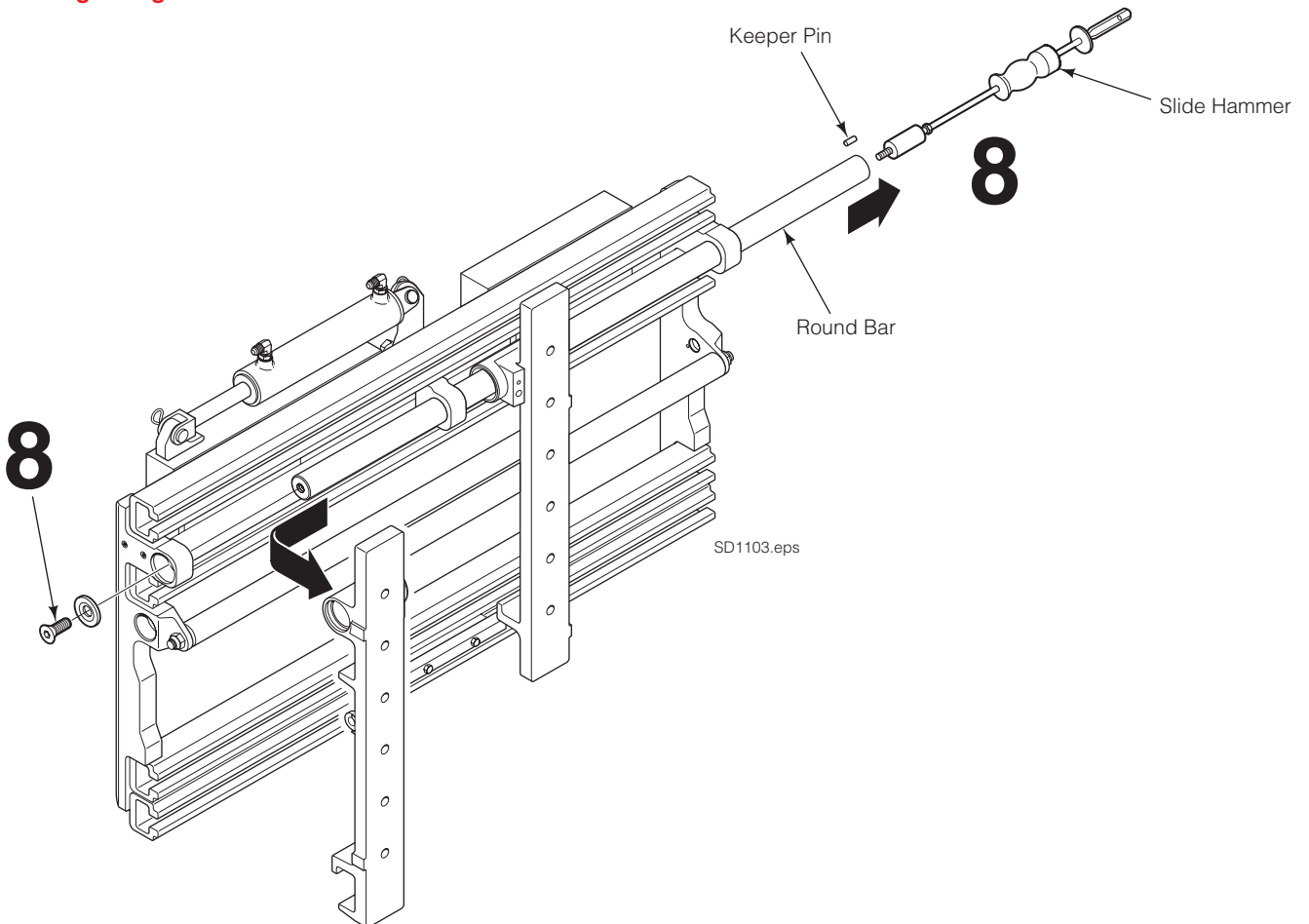

9 For reassembly, reverse the above procedure, except as follows:

- Install new carrier (Type 3 wear pads in place) with kit bearings, bushings and seals. Use a Blind Hole Bearing Puller to install bearings into the carrier.
- Shim carriers as required. Refer to shim installation installations 6148713 (included with kit).
- Guide the outer forks through the inner fork and brake pad.

