



# Installation Instructions

## Electronic Rotational Control 45F Retrofit Kits 6023367 and 6029773

Electronic Rotational Control requires accurately located tapped holes for proper installation. For Cascade Paper Roll Clamps that have not been pre-drilled for ERC, the following steps are recommended for accurately locating the required holes. An overview of the holes being added is shown on page 2. (This list does not determine for the Technician when he needs to dismount the attachment.)

- 1** Using one of the outer race capscrew holes, locate the Switch Bracket jig (6018260) as indicated by the layout on page 3.
- 2** Mark Switch Bracket holes using transfer punch 6019664 (13/64").
- 3** Remove jig.
- 4** Reinstall and tighten the outer race capscrew to 80 ft.-lbs. (110 Nm).
- 5** Drill and tap two Switch Bracket holes (M8 x 1,25) according to layout on page 3.
- 6** Mount Switch Brackets to the Baseplate according to ERC retrofit install instructions (228724). See page 4.
- 7** Mount Faceplate jig (228702) to Switch bracket using M5 cap screws included in ERC retrofit kit. See page 4.
- 8** Tilt the truck mast so that the Short Arm Contact Pad is vertical in the tilting plane.
- 9** Rotate the Paper Roll Clamp until the Short Arm Contact Pad is positioned on the right side (drivers view) and vertical (use a leveling device to ensure accuracy) in the attachment rotating plane.
- 10 Fixed Frame Clamps** – Using the two holes closest to the centerline of the faceplate jig, use transfer punch 6019664 (13/64") to locate new holes in the faceplate. See page 4.  
**Swing Frame Clamps** – Using the two holes closest to the centerline of the faceplate jig, use transfer punch 6019664 (13/64") to locate a new hole in the faceplate and locate the weld on anchor on the edge of the faceplate. Weld the anchor in place with a .25 in. fillet. See page 4.
- 11** Rotate the Paper Roll Clamp clockwise until the Short Arm Contact Pad is down and horizontal in the 'bilge' position (use a leveling device to ensure accuracy).
- 12 Fixed Frame Clamps** – Mark new hole locations the same as step 10.  
**Swing Frame Clamps** – Mark a new hole location and weld an anchor on the faceplate the same as step 10. See page 4.
- 13** Rotate the Paper Roll Clamp until the Short Arm Contact Pad is on the other side from step 9. Ensure the Contact Pad is vertical (use a leveling device to ensure accuracy) in the attachment rotating plane. See page 4.
- 14** Mark new hole locations the same as step 10. See page 4.
- 15** Drill and tap the six faceplate holes (M6 x 1,0) using a tap drill and tap. See page 4.
- 16** Install the relay mounting plate to the baseplate switch bracket. See page 5.
- 17** Proceed as directed by installation instructions 228724.

Part No. 6023066

**cascade**<sup>®</sup>  
**corporation**

**For Technical Support . . .**

Call: 1-800-227-2233 Fax: 1-888-329-8207  
Internet: [www.cascorp.com](http://www.cascorp.com)  
Write: Cascade Corporation, PO Box 20187, Portland, OR 97294

**To Order Parts . . .**

Call: 1-888-227-2233 Fax: 1-888-329-0234  
Internet: [www.cascorp.com](http://www.cascorp.com)  
Write: Cascade Corporation, 2501 Sheridan Ave., Springfield, OH 45505

### Swing Frame Faceplate

Faceplate hole located and anchor located/welded in **step 10**. Tap hole M6 x 1.

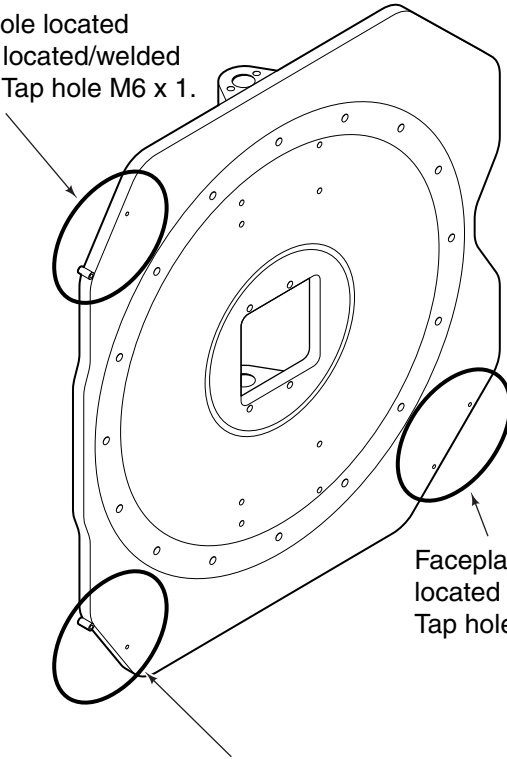

Faceplate holes located in **step 14**. Tap hole M6 x 1.

Faceplate hole located and anchor located/welded in **step 12**. Tap hole M6 x 1.

### Fixed Frame Faceplate

Faceplate hole located in **step 10**. Tap holes M6 x 1.

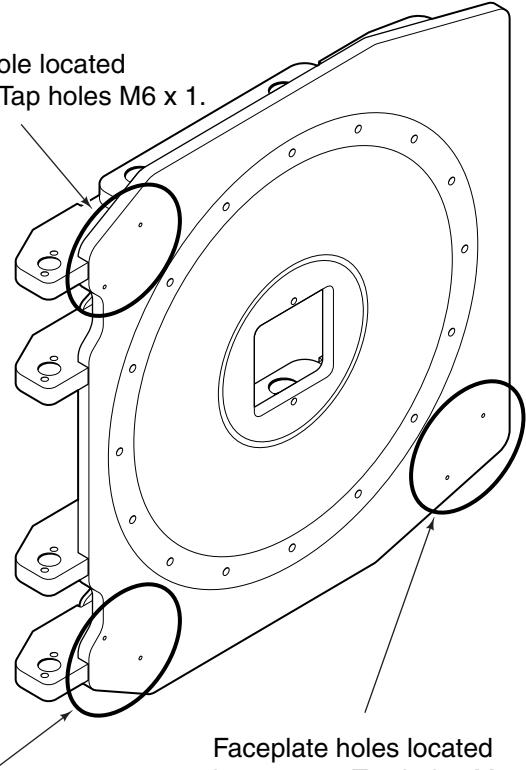

Faceplate holes located in **step 14**. Tap holes M6 x 1.

Faceplate holes located in **step 12**. Tap holes M6 x 1.

Baseplate holes located and drilled in **steps 1 through 5**. Tap holes M8 x 1,25.

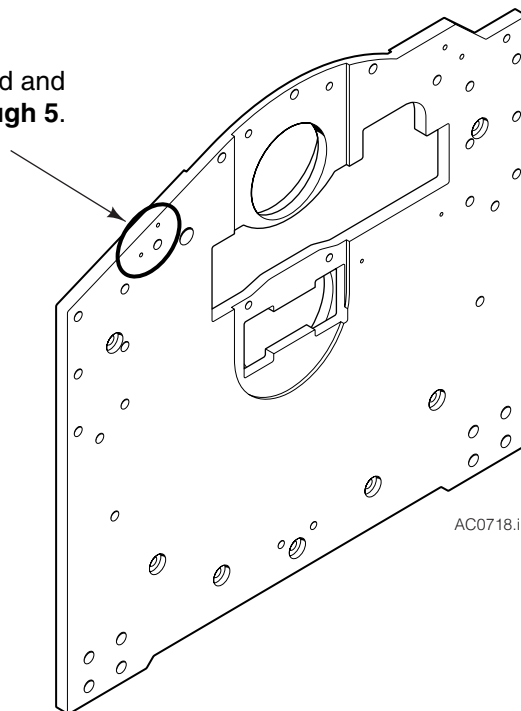

AC0718.iii

Align template edge parallel to edge of baseplate. Mark hole locations as described in **step 2**.

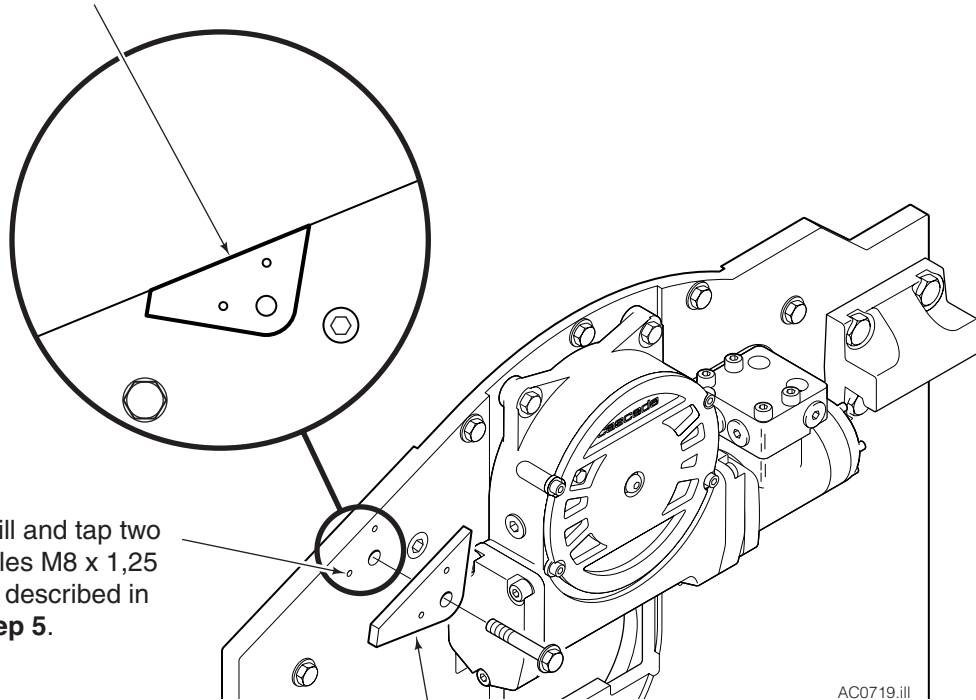

Drill and tap two holes M8 x 1,25 as described in **step 5**.

Install template using existing capscrew as described in **steps 1 and 2**.

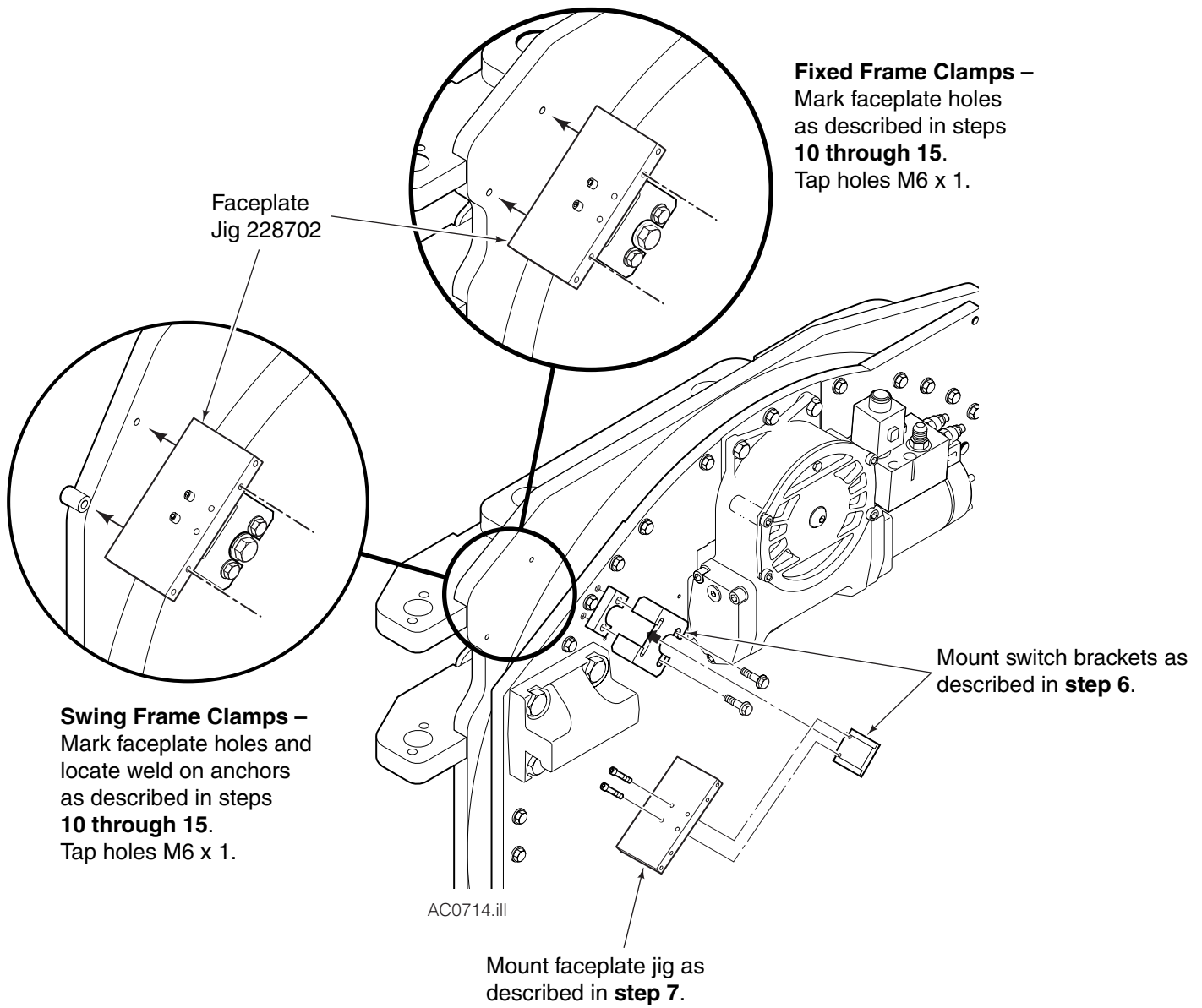

**Swing Frame Clamps**  
Hole and Anchor Locations

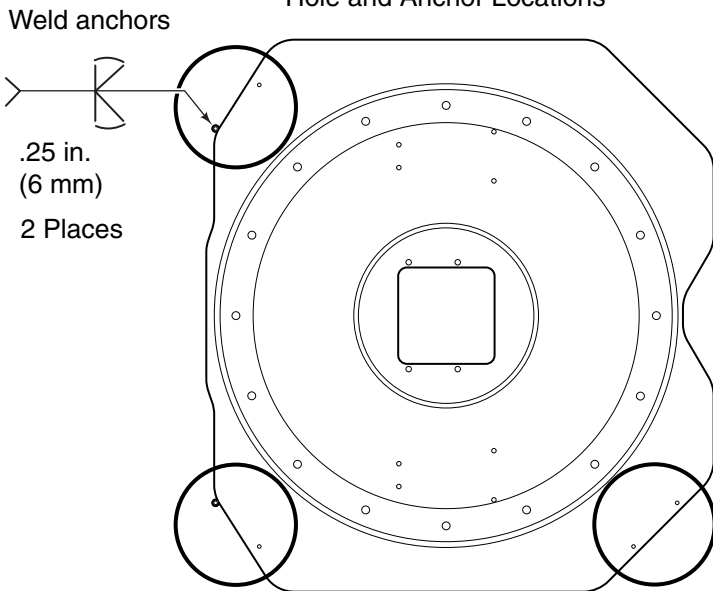

**Fixed Frame Clamps**  
Hole and Locations

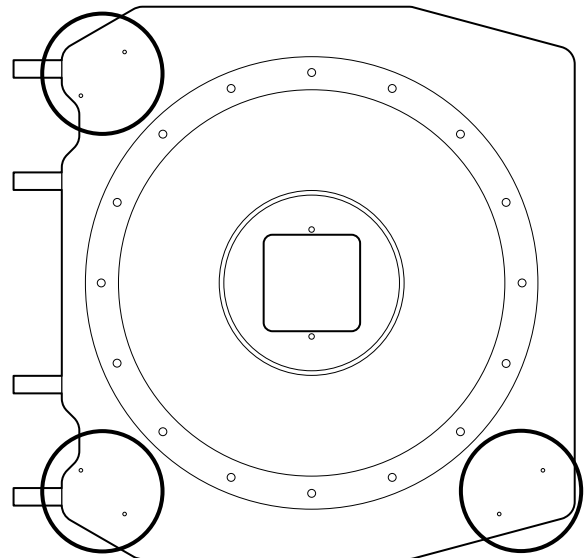

AC0713.iii

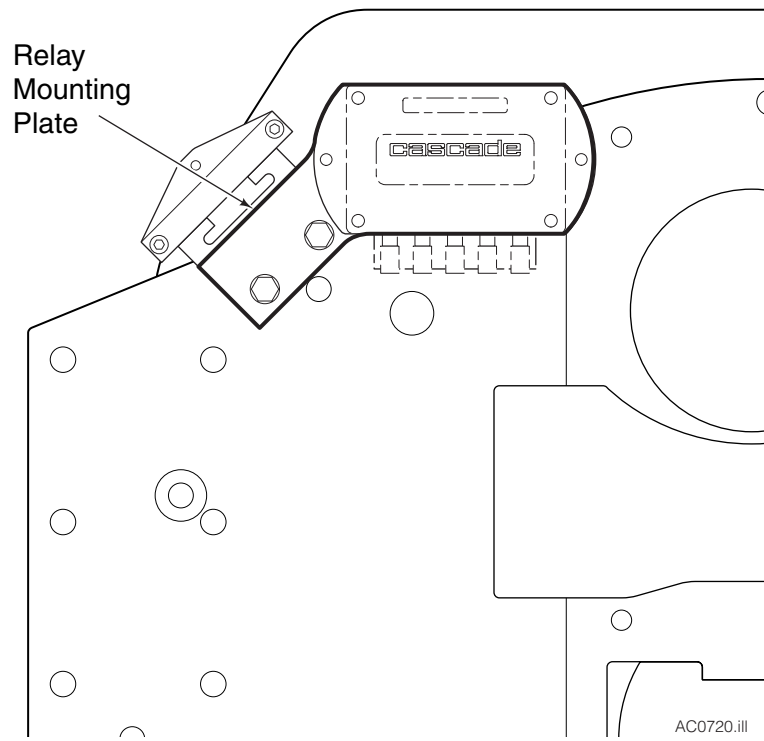

**Do you have questions you need answered right now?** Call your nearest Cascade Service Department. Visit us online at [www.cascorp.com](http://www.cascorp.com)

**Cascade Corporation  
U.S. Headquarters**  
2201 NE 201st  
Fairview, OR 97024-9718  
Tel: 800-CASCADE (227-2233)  
FAX: 888-329-8207

**Cascade Canada Inc.**  
5570 Timberlea Blvd.  
Mississauga, Ontario  
Canada L4W-4M6  
Tel: 905-629-7777  
FAX: 905-629-7785

**Cascade GmbH**  
D-41199 Monchengladbach  
Klosterhofweg 52  
Germany  
Tel: 49-216-668230  
FAX: 49-216-6682323

**Cascade Finland**  
Albert Petreliuksenkatu 3  
01370 Vantaa  
Finland  
Tel: 358-9-836-1925  
FAX: 358-9-836-1935

**Cascade N.V.  
European Headquarters**  
P.O. Box 3009  
1300 El Almere  
Damsluisweg 56  
1332 ED Almere  
The Netherlands  
Tel: 31-36-5492911  
FAX: 31-36-5492964

**Cascade N.V.  
Benelux Sales and Service**  
P.O. Box 3009  
1300 El Almere  
Damsluisweg 56  
1332 ED Almere  
The Netherlands  
Tel: 31-36-5492950  
FAX: 31-36-5492974

**Cascade (UK) Ltd.**  
15, Orgreave Crescent  
Dore House Industrial Estate  
Handsworth  
Sheffield S13 9NQ  
England  
Tel: 742-697524  
FAX: 742-695121

**Cascade Scandinavia AB**  
Box 124  
Hammarvägen 10  
567 23 Vaggeryd  
Sweden  
Tel: 42-0-393-36950  
FAX: 42-0-393-36959

**Cascade Norway**  
Østerliveien 37A  
1153 Oslo  
Norway  
Tel: 47-22-743160  
FAX: 47-22-743157

**Cascade France S.A.R.L.**  
1D Rue De Charaintru  
BP 18, 91360 Epinay-Sur-Orge  
Morangis Cedex, France  
Tel: 33-1-64547500  
FAX: 33-1-64547501

**Cascade Hispania S.A.**  
Carrer 5 Sector C  
Zona Franca Duanera  
Poligono de la Zon Franca  
08040 Barcelona, Spain  
Office No. 256  
Tel: 93-264-07-30  
FAX: 93-264-07-31

**Cascade Japan Ltd.**  
5-5-41,  
Torikai Kami  
Settsu, Osaka  
Japan, 566  
Tel: 81-726-53-3490  
FAX: 81-726-53-3497

**Cascade Korea**  
108B, Namdong Ind Complex  
658-3 Gojan-Dong  
Namdong-Gu  
Inchon, 405-310 Korea  
Tel: 82-32-821-2051  
FAX: 82-32-821-2055

**Cascade Australia**  
1445 Ipswich Road  
Rocklea, QLD 4106  
Australia  
Tel: 1-800227-223  
FAX: (07) 3373-7333

**Cascade New Zealand**  
15 Ra Ora Drive  
East Tamaki, Auckland  
New Zealand  
Tel: 9-273-9136  
FAX: 9-273-9137

**Cascade (Africa) Pty. Ltd.**  
P.O. Box 625, Isando 1600  
60A Steel Road  
Sparton, Kempton Park  
South Africa  
Tel: 975-9240  
FAX: 394-1147

**Cascade-Xiamen**  
No. 668 Yangguang Rd.  
Xinyang Industrial Zone  
Haicang, Xiamen City  
Fujian Province  
P.R. China 361026  
Tel: 86-592-651-2500  
FAX: 86-592-651-2571

**Cascade (Singapore)  
Trading Co.**  
Four Seasons Park  
Autumn Block - Apt. 1802  
12 Cuscaden Walk  
Singapore  
Tel: 65-834-1935  
FAX: 65-834-1936

