



Technical Bulletin

E-Series Sideshifter Lower Hook Installation, Adjustment and Torque Check

When installing Cascade sideshifters, it is critical that the lower hooks be adjusted and tightened as described in this bulletin. **Improper adjustment and over or under tightening of the lower hooks may result in the sideshifter disengaging from the truck carriage possibly causing serious injury or property damage.** In the past Cascade has provided two types of nuts (Type A and B shown) for the lower hooks. We have learned that the Type A nuts are less likely to tolerate overtightening and we are making Type B nuts (part no. 553857) available for retrofitting.

To improve safety and efficiency, take the following preventative steps:

- At the next service interval, inspect the lower hooks condition, adjustment, torque and nut type installed.
- **Replace all Type A nuts with Type B nuts supplied by Cascade and installed following the steps outlined in this bulletin.**
- Check the lower hook capscrew torque during installation and at the recommended maintenance intervals.

Cascade will supply an initial quantity of Type B nuts for your service technicians and customers. Contact Cascade's service department for additional quantities of nuts at no charge.

- 1 Adjust the lower hooks up tight to the truck carriage bar, then back off one rib position. The clearance between the hook and truck carriage bar should be 1/16 in. minimum to 1/8 in. maximum. Tighten the capscrews finger tight.
- 2 Tighten the capscrews to a final torque of 115-125 ft.-lbs. with a manual torque wrench.

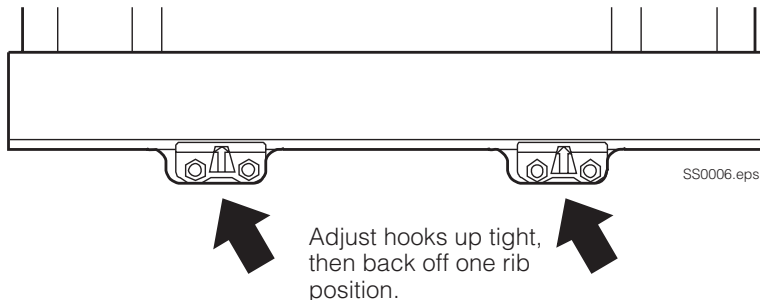

Type A
Nylon Insert

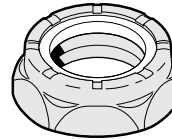

Type B
Crimped

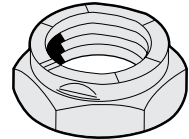

SS0116.ill

Replace all Type A nuts with Type B nuts.



WARNING: Improper installation, adjustment and over or under torquing of the lower hook capscrews may result in the sideshifter disengaging from the truck carriage possibly causing serious injury or property damage. Check the capscrews torque every 500 hours.

WARNING: The use of pneumatic tools for torquing is not recommended. Improperly set and non calibrated pneumatic tools increase the potential for over tightening and stripping the bolts and nuts. Final torque should be applied with a properly calibrated manual torque wrench.

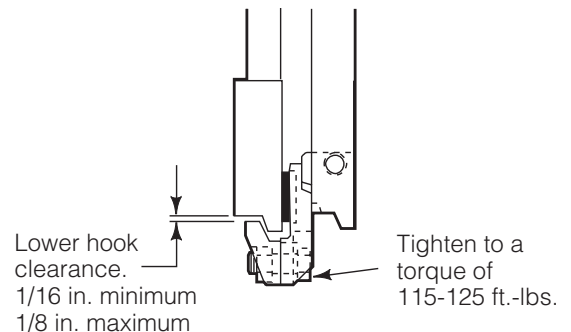

NOTE: This information should not be interpreted as the basis for warranty claims unless so designated.

Part No. 214035

cascade[®]

For Technical Assistance and to Order Parts . . .

Call: 1-800-CASCADE or 503-669-6300

FAX: 503-669-6367

Write: Cascade Corporation, PO Box 20187, Portland, OR 97220



Additional Nut Request Form

Return this form to Cascade Corporation
by FAX: 503-669-6367

Company

Address

City

State

ZIP

Contact

Phone No.

FAX No.

Quantity of additional nuts (supplied in lots of 60)
