



Installation Instructions

Mark 55 Radio Frequency (RF) Hydraulic Control Kits 6086562, 6096074, 6096075, 6096081 and Conversion Kit 6096076

This sheet provides installation instructions and replacement parts list for Cascade Hydraulic Control Kits 6086562, 6096074, 6096075, 6096081 and Cascade Conversion Kit 6096076. The kits provide two function operation using a single function hydraulic supply and radio frequency (RF) solenoid actuation to select the push/pull or platen position functions. The attachment mounted solenoid is battery powered and driver activated by a remote transmitter mounted on the truck.

CAUTION: If the truck or attachment will be cleaned with a pressure washer, remove the battery and receiver from the attachment prior to cleaning. High pressure water can damage the battery and receiver.

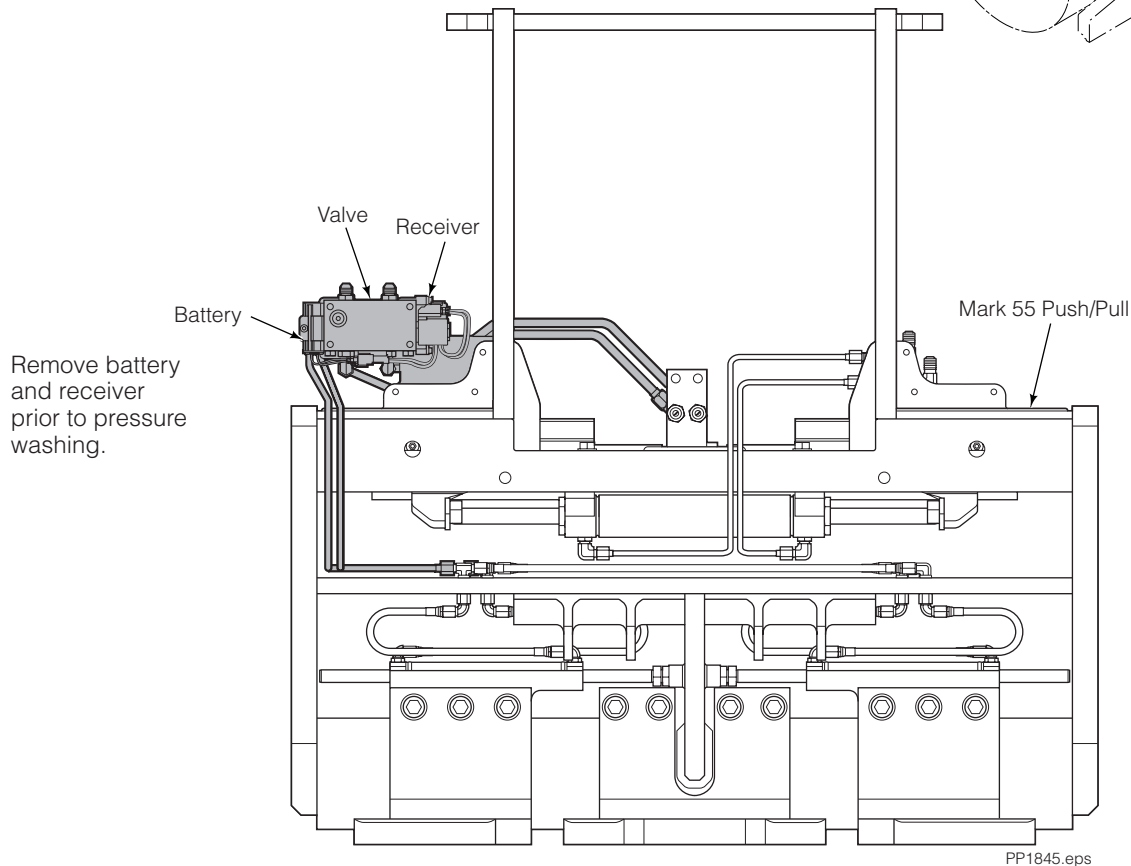
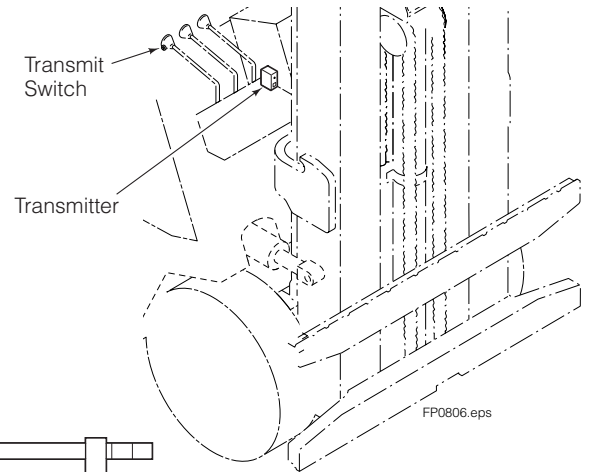

cascade[®]
corporation

For Technical Support . . .

Call: 1-800-227-2233 Fax: 1-888-329-8207
Internet: www.cascorp.com
Write: Cascade Corporation, PO Box 20187, Portland, OR 97294

To Order Parts . . .

Call: 1-888-227-2233 Fax: 1-888-329-0234
Internet: www.cascorp.com
Write: Cascade Corporation, 2501 Sheridan Ave., Springfield, OH 45505

Conversion Kit 6096076 Installation

The following instructions describe how to install the Radio Frequency Hydraulic Control kit. The kit includes new valve, tubes, brackets, receiver, transmitter, battery, and battery charger.



WARNING: Before removing any hoses, relieve pressure in the hydraulic system. With the truck off, open the truck auxiliary control valve(s) several times in both directions.

- 1 Remove existing solenoid valve(s), tubes, cables and brackets. If equipped, remove battery and receiver.
- 2 Mount bracket to attachment and tighten capscrews to 13-15 ft.-lbs. (18-20 Nm).

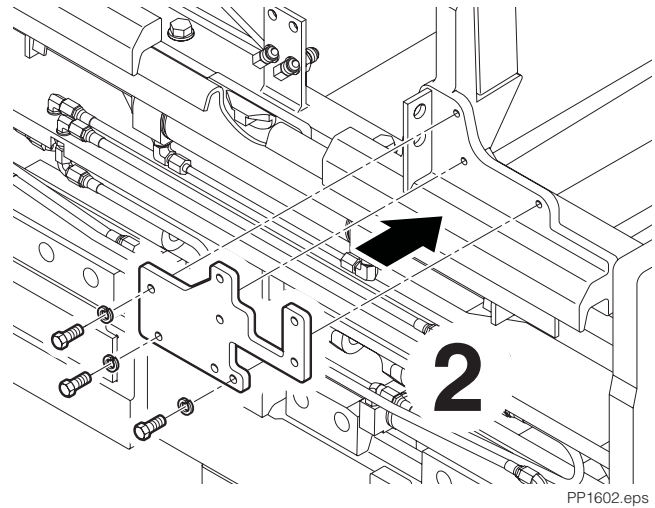

- 3 Install fittings to the valve.

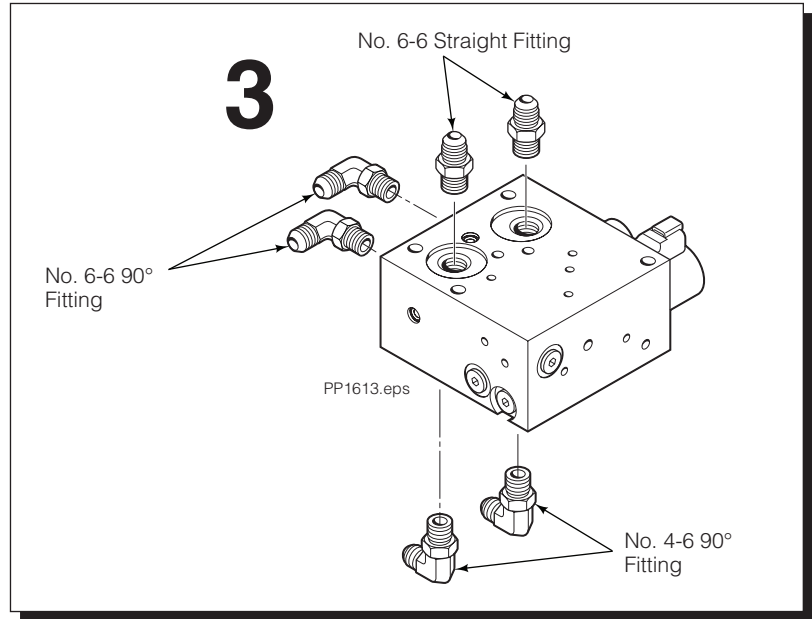

- 4 Mount valve to bracket and tighten capscrews to 13-15 ft.-lbs. (18-20 Nm).

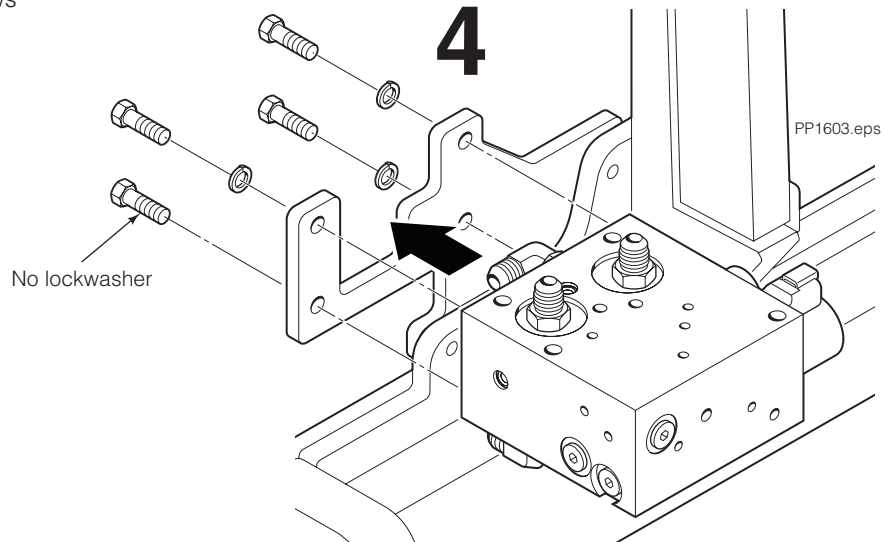

5 Mount battery clip and receiver clip to valve.

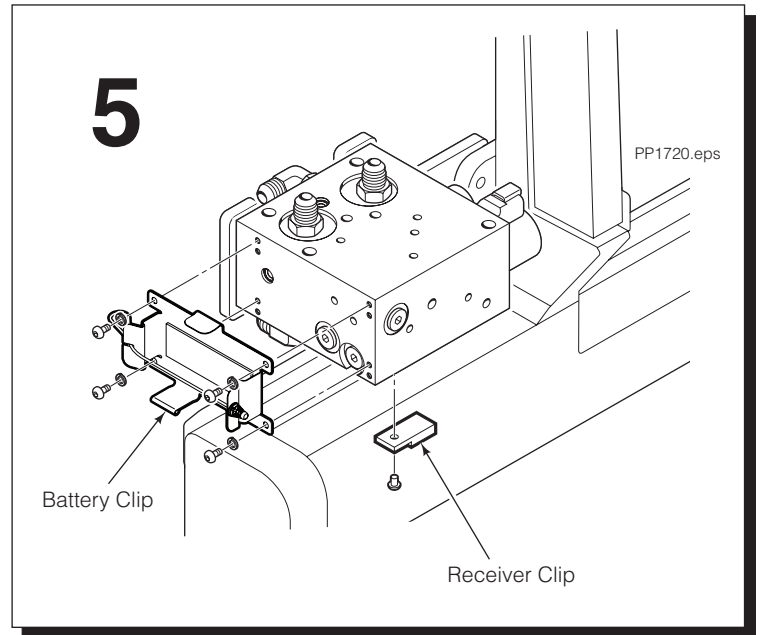

6 Pull latch on battery clip. Install battery into battery clip and secure latch.

7 Mount bracket and receiver to valve. Connect receiver plugs to battery plug and solenoid valve.

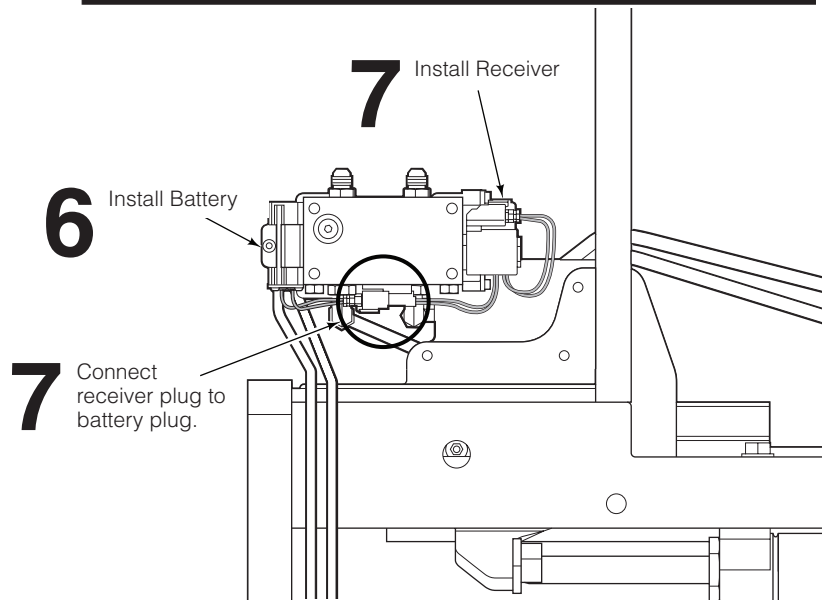

8 Install tubes and supply hoses.

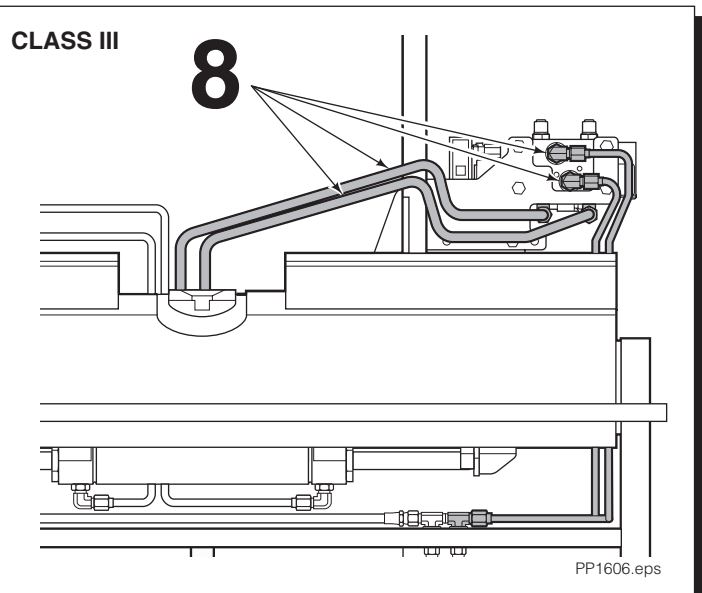
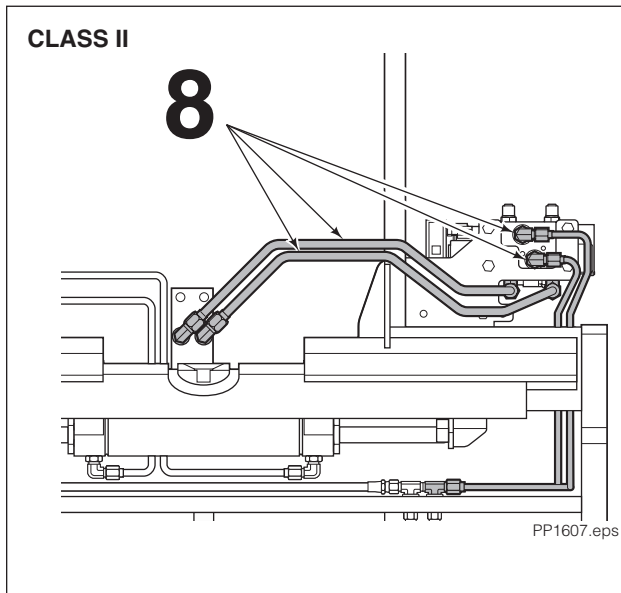

9 Install valve cover and tighten capscrews to 13-15 ft.-lbs. (18-20 Nm).

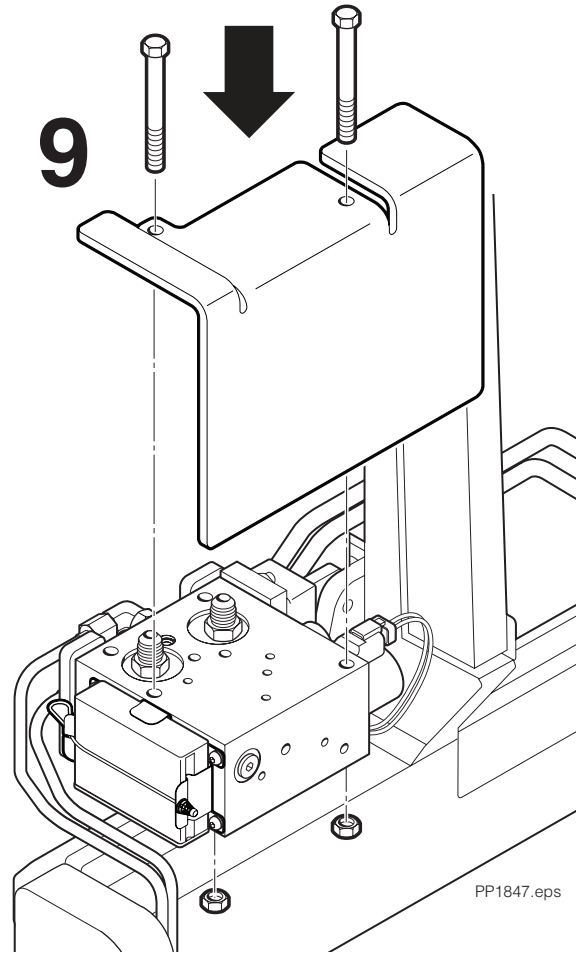

10 If kit includes knob or pushbutton switch:

Knob – Remove existing knob from Push/Pull auxiliary valve handle. Install the new knob using the adapter provided.

Push Button Switch – Install the push button switch to the push/pull knob. Position switch on the handle in a location for comfortable thumb or index finger operation. Place the double sided tape under the switch to secure the switch to the handle.

NOTE: Secure the cable so it will not be pinched when the handle is actuated.

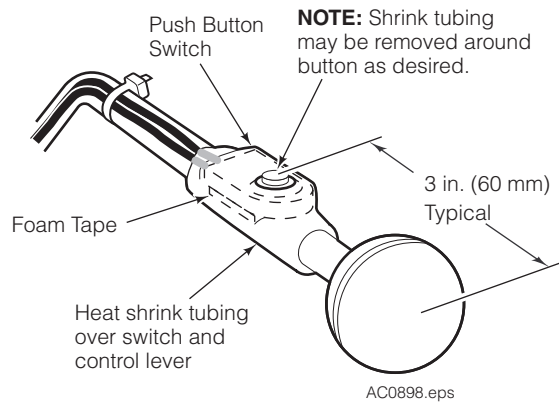
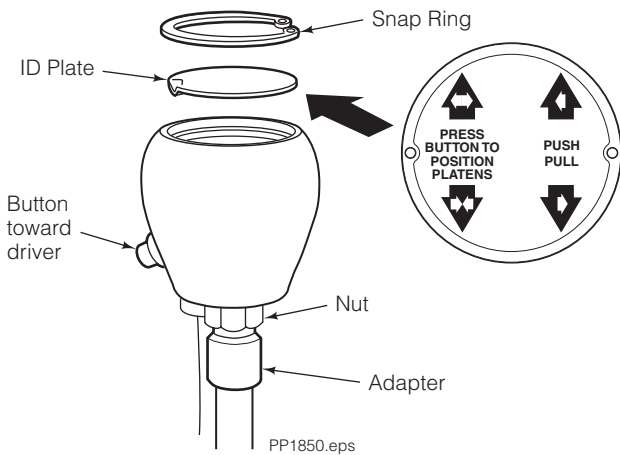

Transmitter Installation

1 Install the transmitters above dashboard in an easy to view and accessible location for the driver. Provide at least 8 in. (20 cm) clearance between the driver and transmitter.

IMPORTANT: The transmitter must not be co-located or operating in conjunction with any other antenna or transmitter.

2 Connect each transmitter red wire to a switched terminal on the truck fuse block. Connect the black wires to chassis ground. Connect each transmitter's two remaining wires to a control knob transmit switch. Use Cascade Control Knob Kit 673130 or Switch Kit 6014880 (two kits required).

IMPORTANT: The resistor connected to the red wire is for use on trucks operating at 31V to 80V. Remove the resistor on trucks operating at 30V or less.

Use Control Knob Kit 355058 **OR** Switch Kit 6014880

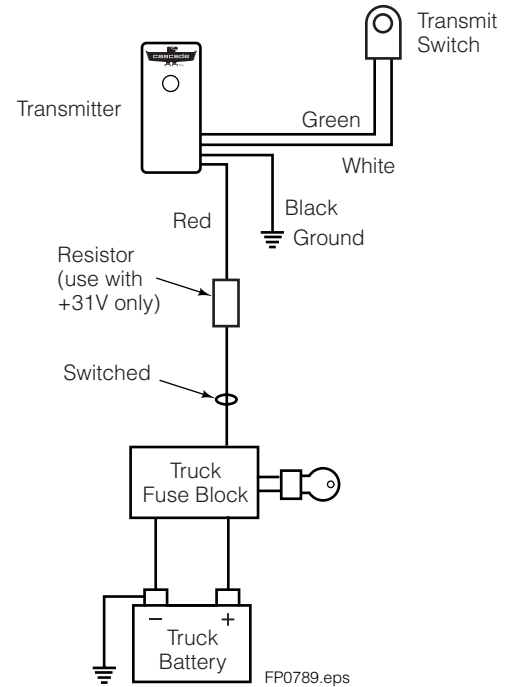

Operation

Verify that each transmitter has been properly connected to truck battery and each receiver is plugged into its battery. The light on the transmitter and receiver will operate as follows:

- No signal light: Check transmitter supply voltage. If transmitter voltage is not the problem, install charged battery on the receiver.
- Solid/flashing green: Transmitter and receiver have adequate power and are working properly.
- Solid/flashing red: Receiver battery is low, replace with charged battery.

NOTE: After one hour of inactivity, the receiver goes into sleep mode to conserve power. Press and hold the transmit switch for two seconds to wake the unit for operation.

Battery

NOTE: Charge new batteries prior to use.

Chargers available are listed:

Location	Battery Charger
	Part No.
North America	6079239
Australia	6079700
United Kingdom	6079701
Europe	6079699

Voltage switch on the charger should be set to 10.8V/11.1V.

Hydraulic Control Kit

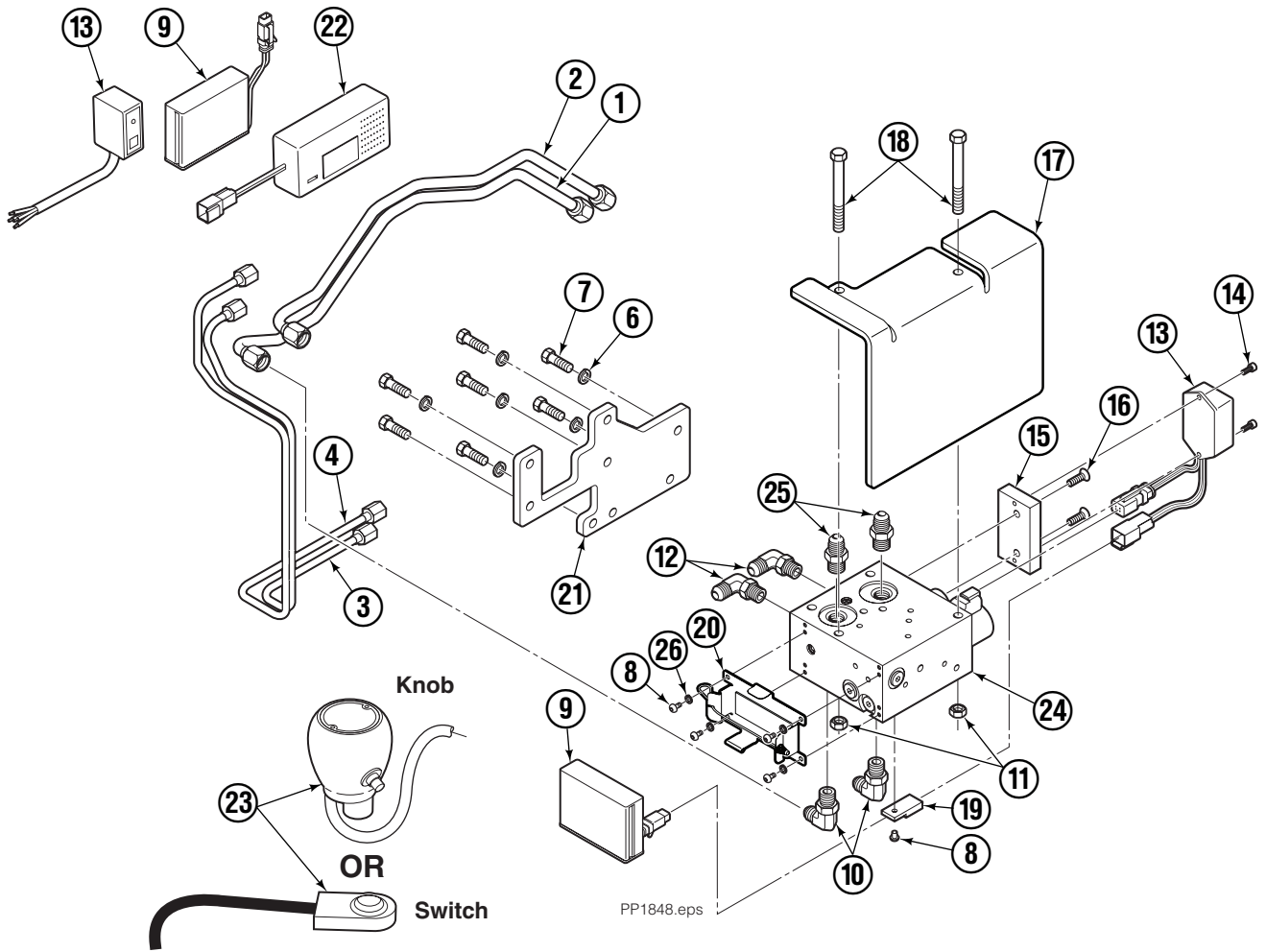

REF	QTY	PART NO.	DESCRIPTION	REF	QTY	PART NO.	DESCRIPTION
		6086562	RF Solenoid Adaption Kit – CL III	11	2	767414	Nut, M8
		6096074	RF Solenoid Adaption Kit – CL II	12	2	666984	Fitting, 4-6
		6096075	RF Solenoid Adaption Kit Low Profile – CL II	13	1	6805751	RF Transmission Kit
		6096076	RF Solenoid Conversion Kit – CL II	14	2	6405488	Capscrew, M4 x 10
		6096081	RF Solenoid Adaption Kit Low Profile – CL III	15	1	6805733	Receiver Mounting Plate
1	1	6095161 ◆	Tube Assembly	16	2	763052	Capscrew, M6 x 20
		6086539 ■		17	1	6095158	Valve Protection Bracket
2	1	6095160 ◆	Tube Assembly	18	2	6405022	Capscrew, M8 x 80
		6086538 ■		19	1	6079201	Receiver Clip
3	1	6095162 ◆	Tube Assembly	20	1	6094986	Battery Clip
		6086541 ■		21	1	6095159	Bracket
4	1	6095163 ◆	Tube Assembly	22	1	6079239	Battery Charger, Lithium Ion
		6086540 ■		23	1	355058	Knob Assembly ▲
6	✘	787384	Lockwasher, M8			6014880	Operator Control Switch Kit ★
7	✘	787372	Capscrew, M8 x 20	24	1	6070947	Valve Assembly ●
8	5	6076098	Button Head Capscrew, M4	25	2	604511	Fitting, 6-6
9	2	6075736	Battery	26	4	685899	Lockwasher, M4
10	2	601676	Fitting, 6-6				

▲ Included with kit 6096074 and 6086562. See Knob Assembly page for parts breakdown.

● See Valve Assembly page for parts breakdown.

◆ Included in kits 6096074, 6096075 and 6096076.

■ Included in kits 6096080 and 6096081.

★ Included with kits 6096075 and 6096081. See Control Switch Kit page for parts breakdown.

✘ Quantity varies per kit.

Control Knob Two Function

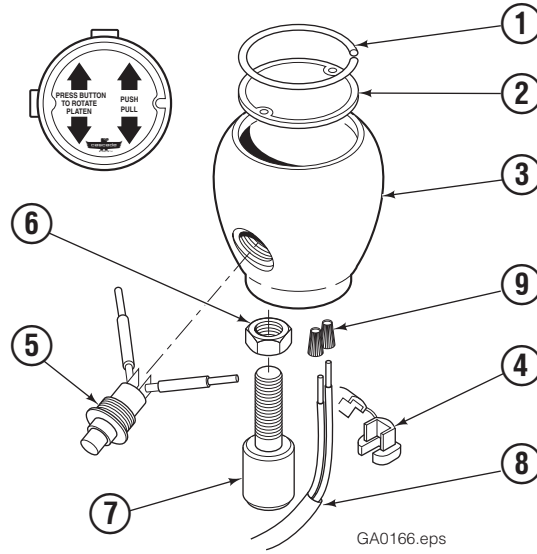

REF	QTY	PART NO.	DESCRIPTION
		355058	Knob Group
1	1	665250	Snap Ring
2	1	355059	Cover
3	1	665012	Knob
4	1	665076	Strain Relief
5	1	677112	Switch ■
6	1	5902	Nut, 3/8 NC
7	1	665081	Adaptor
8	1	667718	Cable Assembly
9	2	667752	Connector – Gray

■ This switch may be purchased without wires. Order part number 665004. Soldering is required.

Low Profile Switch Kit

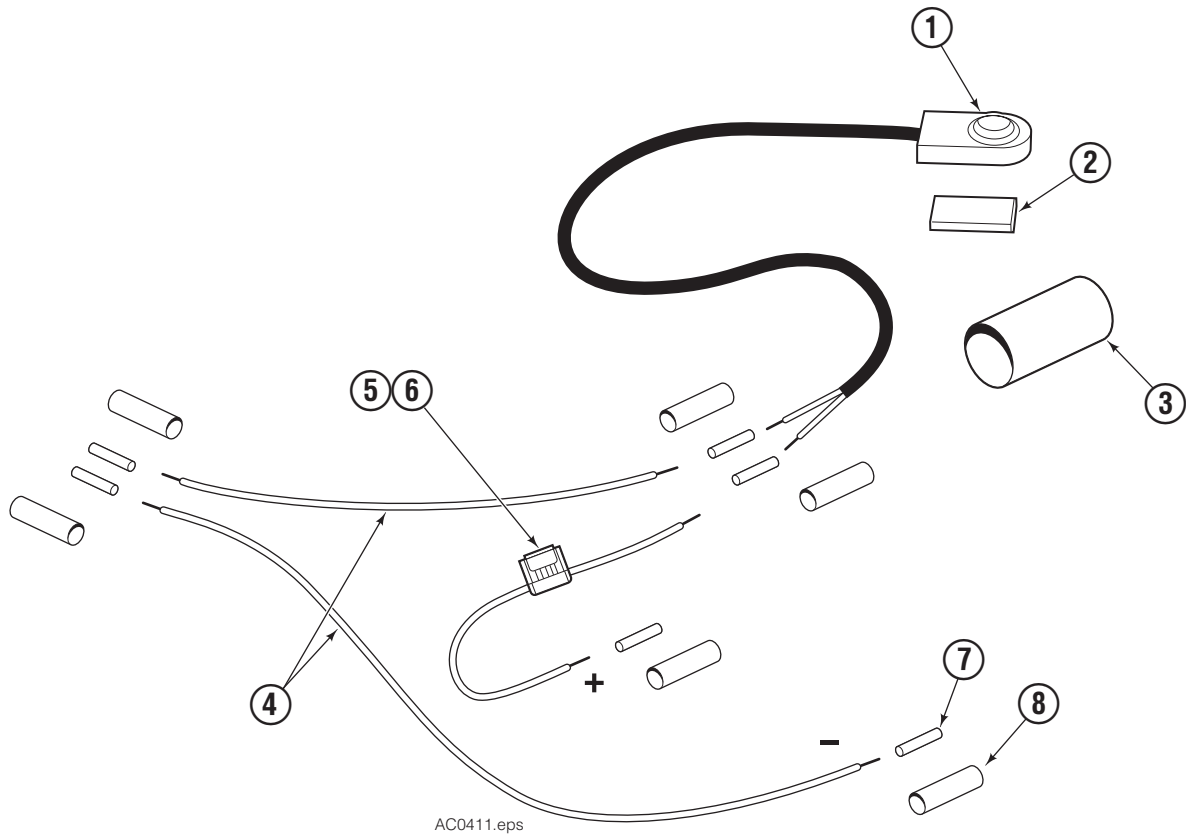

REF	QTY	PART NO.	DESCRIPTION
		6014880	Operator Control Switch Kit
1	1	6009928	Switch
2	1	6014987	Double Sided Tape
3	1	6001641	Shrink Tube
4	1	6014990	Wire – 18 AWG
5	1	228154	Fuse – 7.5 Amp
6	1	219402	Fuse Holder
7	6	6014986	Connector
8	6	6016648	Shrink Tube

Valve Assembly

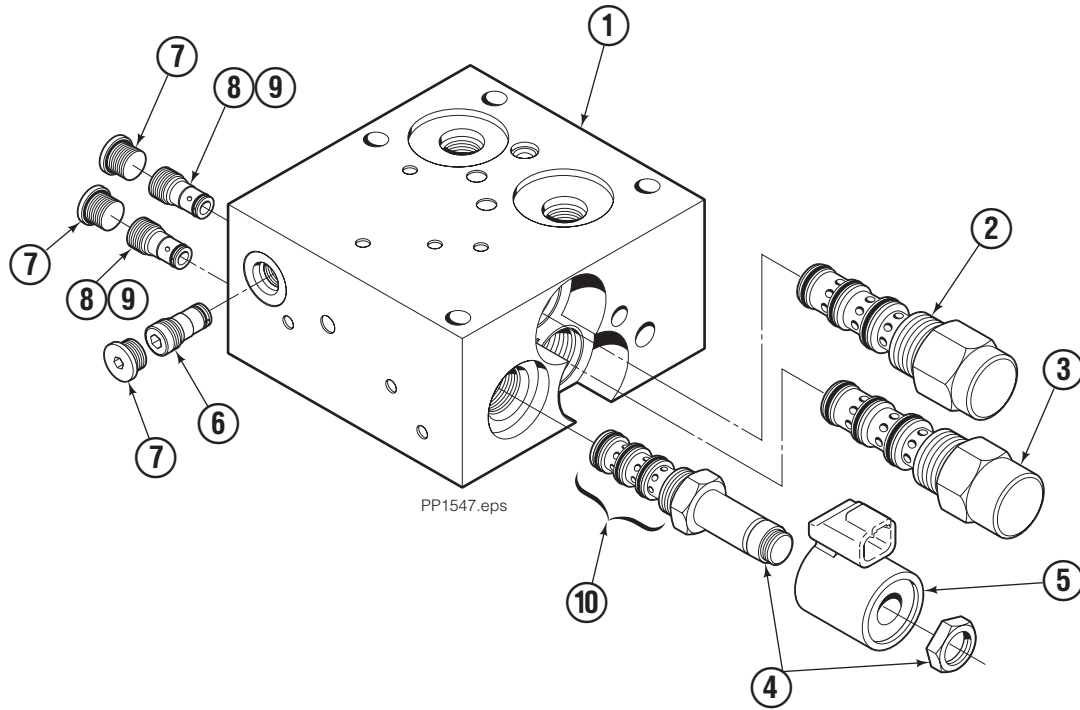

REF	QTY	PART NO.	DESCRIPTION
		6070947	Valve Assembly
1	1	6070946	Valve Body
2	1	6069787	Cartridge
3	1	6069792	Cartridge
4	1	220627	Solenoid Valve Cartridge
5	1	6054451	Solenoid Coil, 10 VDC
6	1	220865	Shuttle Valve
7	3	609234	Plug
8	2	6057940	Check Valve Cartridge
9	2	6025595	Service Kit
10	1	221049	Service Kit

Do you have questions you need answered right now? Call your nearest Cascade Service Department. Visit us online at www.cascorp.com

AMERICAS

Cascade Corporation Parts Sales

2501 Sheridan Ave.
Springfield, OH 45505
Tel: 888-CASCADE (227-2233)
Fax: 888-329-0234

Cascade Canada Inc.

5570 Timberlea Blvd.
Mississauga, Ontario
Canada L4W-4M6
Tel: 905-629-7777
Fax: 905-629-7785

Cascade do Brasil

Rua João Guerra, 134
Macuco, Santos - SP
Brasil 11015-130
Tel: 55-13-2105-8800
Fax: 55-13-2105-8899

EUROPE-AFRICA

Cascade Italia S.R.L. European Headquarters

Via Dell'Artigianato 1
37050 Vago di Lavagno (VR)
Italy
Tel: 39-045-8989111
Fax: 39-045-8989160

Cascade (Africa) Pty. Ltd.

PO Box 625, Isando 1600
60A Steel Road
Sparton, Kempton Park
South Africa
Tel: 27-11-975-9240
Fax: 27-11-394-1147

ASIA-PACIFIC

Cascade Japan Ltd.

2-23, 2-Chome,
Kukuchi Nishimachi
Amagasaki, Hyogo
Japan, 661-0978
Tel: 81-6-6420-9771
Fax: 81-6-6420-9777

Cascade Korea

121B 9L Namdong Ind.
Complex, 691-8 Gojan-Dong
Namdong-Ku
Inchon, Korea
Tel: +82-32-821-2051
Fax: +82-32-821-2055

Cascade-Xiamen

No. 668 Yangguang Rd.
Xinyang Industrial Zone
Haicang, Xiamen City
Fujian Province
P.R. China 361026
Tel: 86-592-651-2500
Fax: 86-592-651-2571

Cascade India Material Handling Private Limited

No 34, Global Trade Centre
1/1 Rambaugh Colony
Lal Bahadur Shastri Road,
Navi Peth, Pune 411 030
(Maharashtra) India
Phone: +91 020 2432 5490
Fax: +91 020 2433 0881

Cascade Australia Pty. Ltd.

1445 Ipswich Road
Rocklea, QLD 4107
Australia
Tel: 1-800-227-223
Fax: +61 7 3373-7333

Cascade New Zealand

15 Ra Ora Drive
East Tamaki, Auckland
New Zealand
Tel: +64-9-273-9136
Fax: +64-9-273-9137

Sunstream Industries Pte. Ltd.

18 Tuas South Street 5
Singapore 637796
Tel: +65-6795-7555
Fax: +65-6863-1368

