

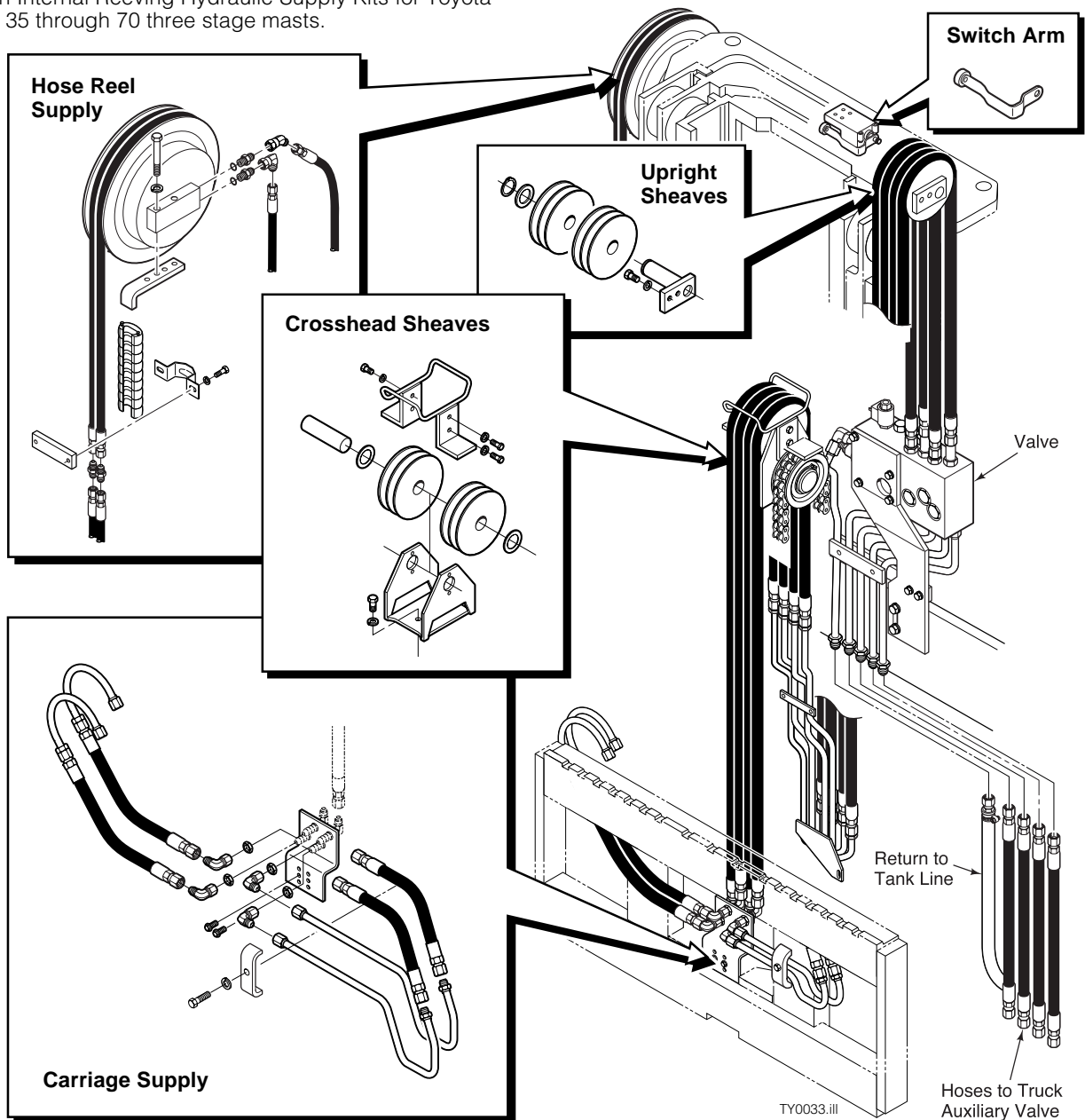

Installation Instructions

Toyota Three Function Internal Reeving Hydraulic Supply Kits

This sheet describes the installation of Cascade Three Function Internal Reeving Hydraulic Supply Kits for Toyota 7FGCU 35 through 70 three stage masts.



cascade[®]
corporation

For Technical Support . . .

Call: 1-800-227-2233

OR

Write: Cascade Corporation, P.O. Box 20187, Portland, OR 97294

To Order Parts . . .

Call: 1-888-227-2233

OR

Write: Cascade Corporation, 2501 Sheridan Ave., Springfield, OH 45505

- 1 Raise the mast inner upright to gain access to the outer upright center crossmember.
- 2 Install the valve mounting plate to the front side of the outer upright center crossmember. Tighten the capscrews to a torque of 16 ft.-lbs. (22 Nm).
- 3 Install the valve to the back of the mounting plate. Tighten the capscrews to a torque of 16 ft.-lbs. (22 Nm).
- 4 **7FGCU 35/45**—Install fittings to the valve. Install tubes and hoses to the valve bottom and side No. 8 fittings. Route the tubes on the front side of the crossmember. Install No. 6 hoses to the bottom No. 6 fittings.

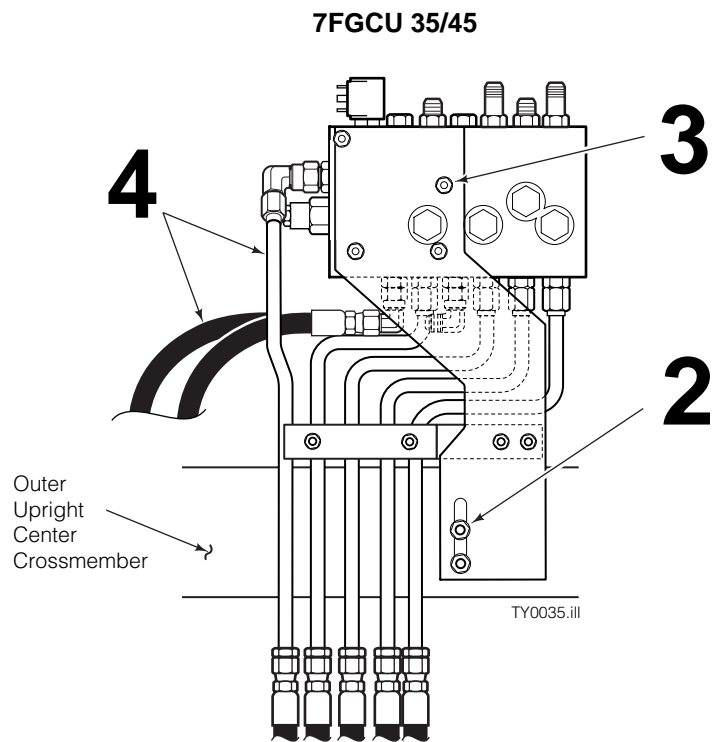
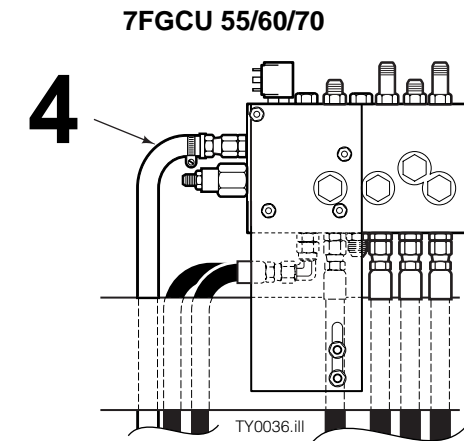

- 5 Install the tube assembly to the back of the inner upright. Tighten the capscrews to a torque of 16 ft.-lbs. (22 Nm).

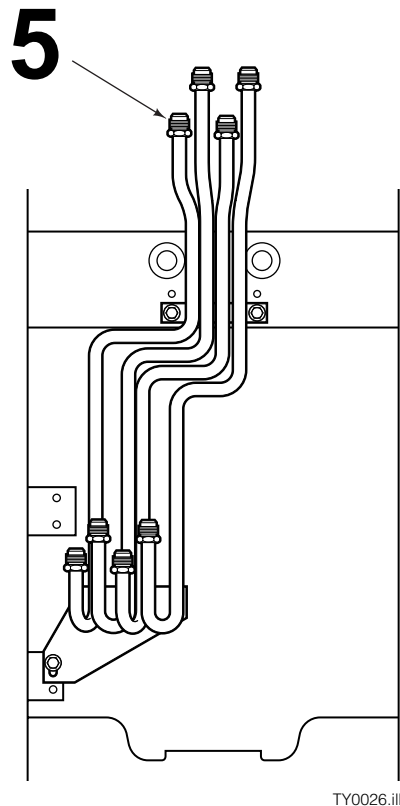
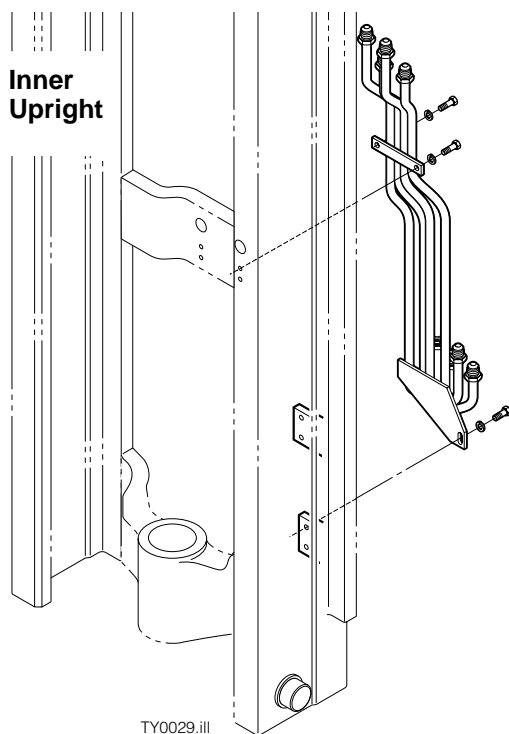

- 6** Install the bulkhead fittings to the carriage bracket. Install the hoses to the bulkhead fittings.
- 7** Route the hose ends through the carriage and up toward the cylinder crosshead.
- 8** Install the carriage bracket to the center tab on the lower carriage bar. Leave the capscrews finger tight for hose adjustment.
- 9** Install the fittings, hoses and tubes to the carriage bracket. Install the tube clamp and tack weld to the carriage.

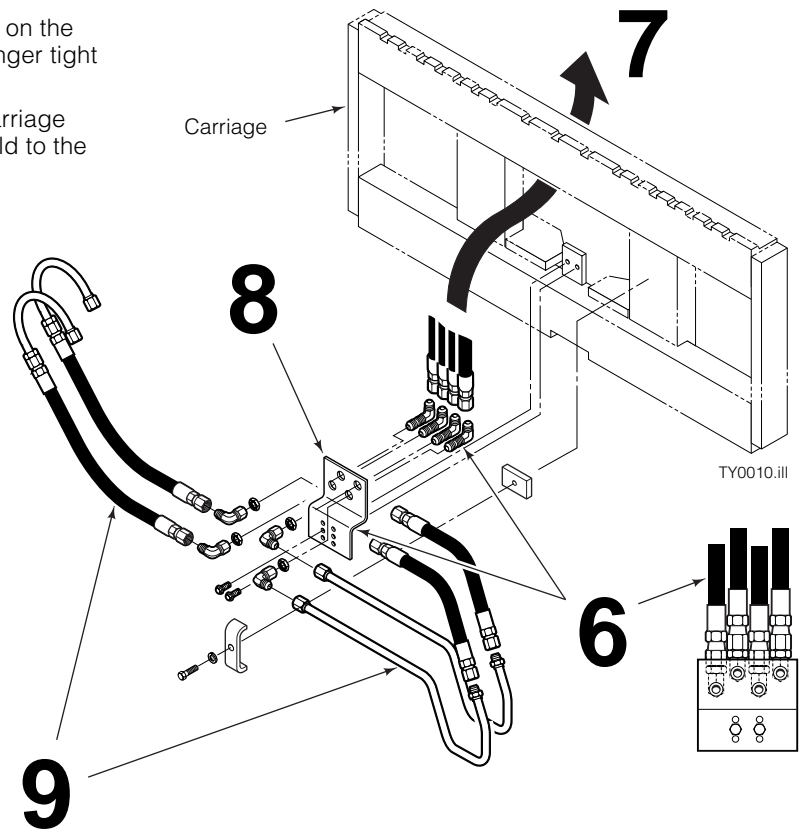

- 10** Install the crosshead bracket to the freelif cylinder. Tighten the capscrews to a torque of 16 ft.-lbs. (22 Nm).
- 11** Install the sheaves, shaft and hoses to the crosshead bracket. Route the loose hose ends down the back side of the cylinder.
- 12** Install the crosshead guard. Tighten the capscrews to a torque of 16 ft.-lbs. (22 Nm).

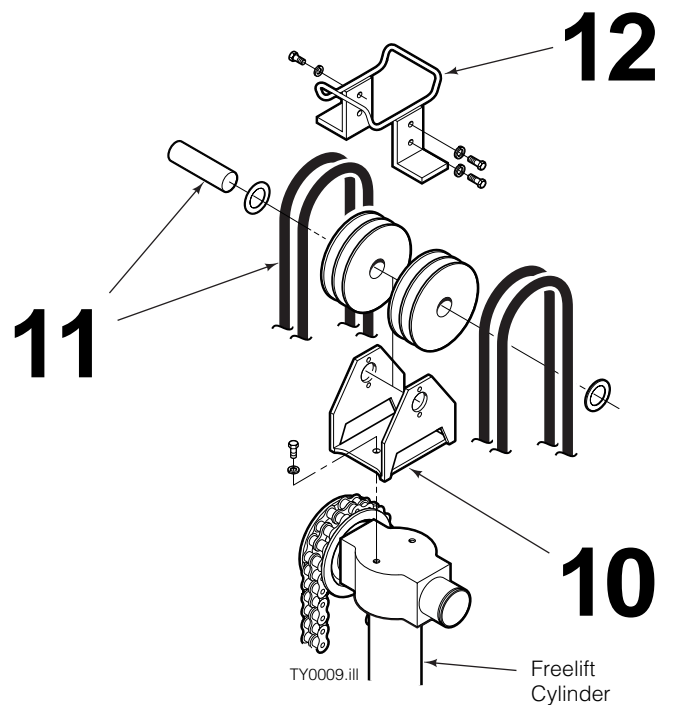

- 13** Remove the bracket from the intermediate upright if necessary to make room for the hose sheave assembly installed in the next step.

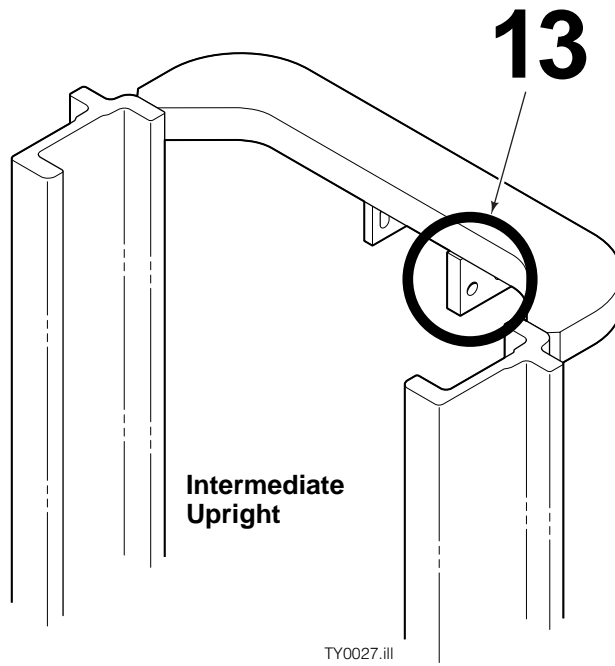

- 14** Install the hose sheave assembly and hoses to the intermediate upright chain sheave stub shaft. Tighten the capscrews to a torque of 16 ft.-lbs. (22 Nm).

- 15** Install the replacement switch arm if included in the kit.

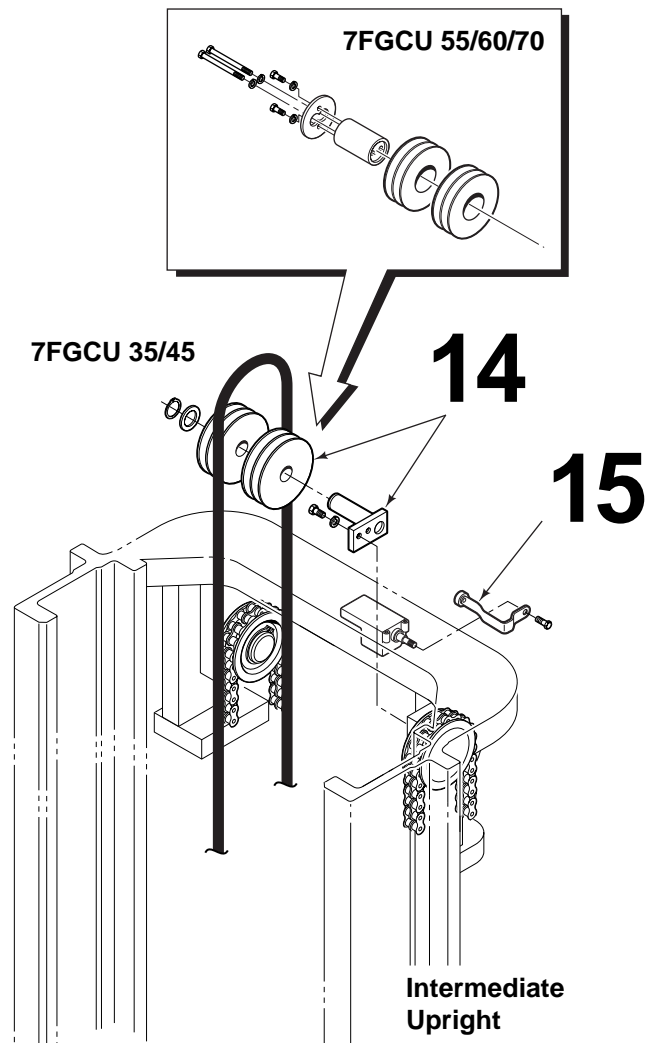

- 16** Raise the carriage 12 in. (30 cm).
- 17** Connect the free lift hoses to the upper fittings of the tube assembly. Connect the hoses to the longer tube fittings first. Lower the carriage.
- 18** Connect the main lift hoses to the lower fittings of the tube assembly. Connect the hoses to the longer tube fittings first.
- 19** Connect the main lift hoses to the valve fittings. Connect the hoses to the shorter fittings first.

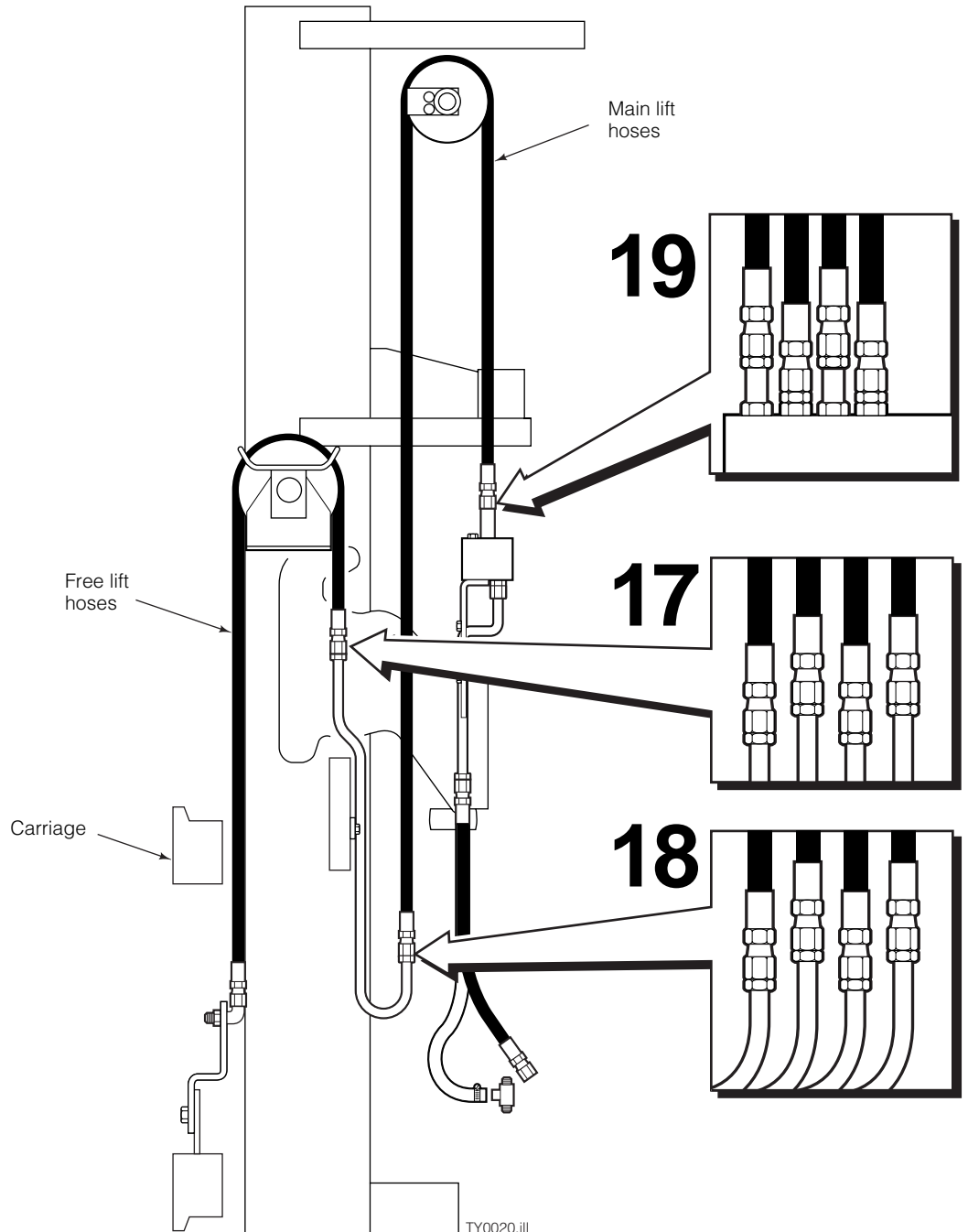

20 Install the valve tank line hose end to the truck tank circuit using the push lock tee fitting and clamps.

21 Install the No. 8 hose ends from the bottom of the valve to the truck auxiliary valve circuit for the Rotate and Clamp circuits.

20 Connect tank line to truck tank circuit.

21 Connect hoses to truck auxiliary valve.

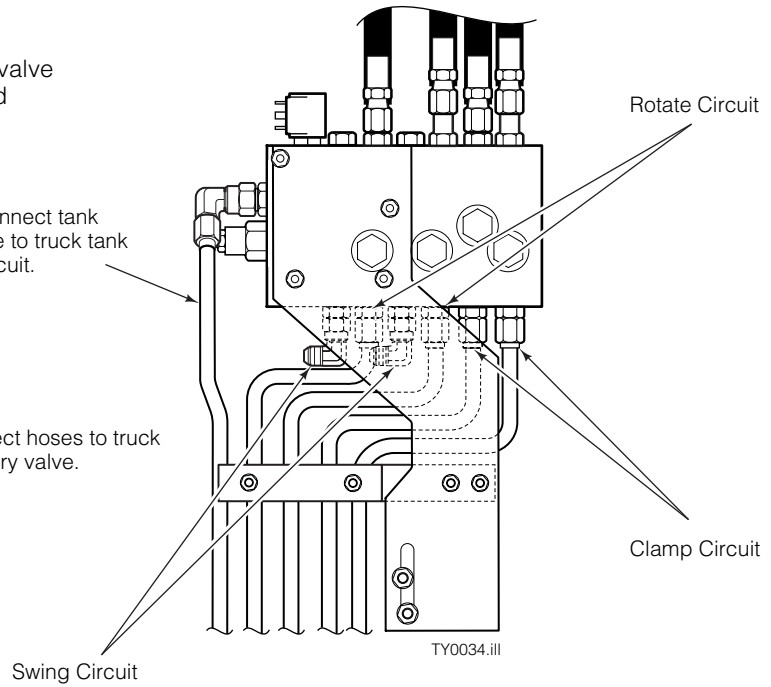

Hose Adjustment

- 1** Raise and lower the mast slowly through several cycles checking for proper hose alignment, clearances and hose tracking.
- 2** Adjust the free lift hose tension by adjusting the carriage bracket position.
- 3** Adjust the main lift hose tension by adjusting the valve bracket position.

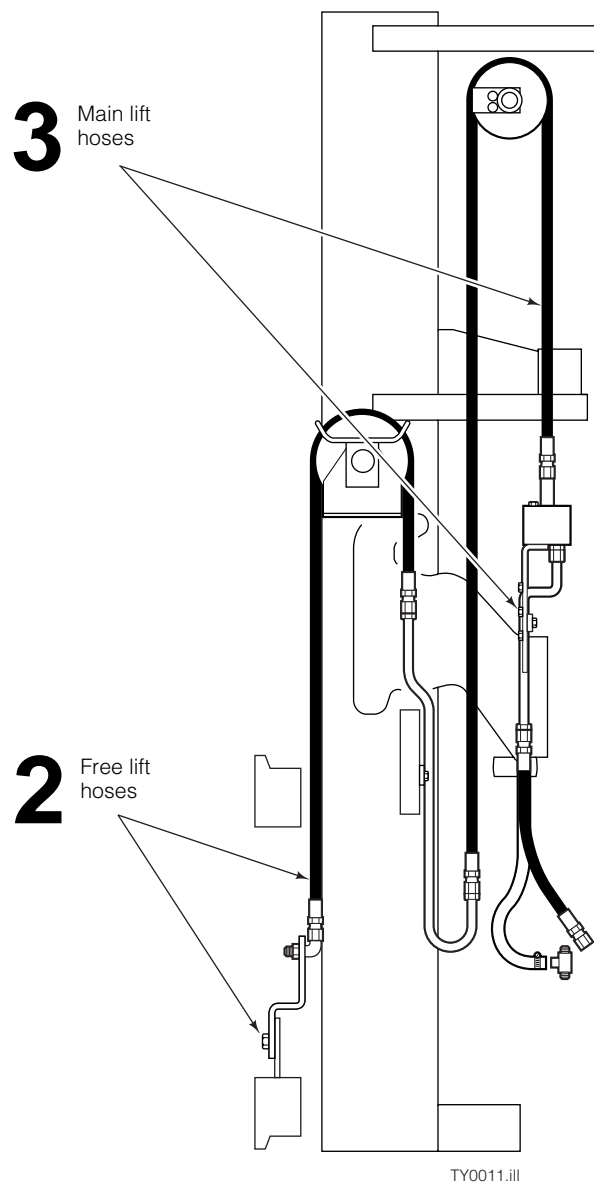

Hose Reel Installation

- 1 Determine a mounting location for the hose reel on the right side of the outer upright. Position the reel to provide the minimum clearances shown. Weld the bracket to the outer upright.
- 2 Install fittings to the hose reel body.

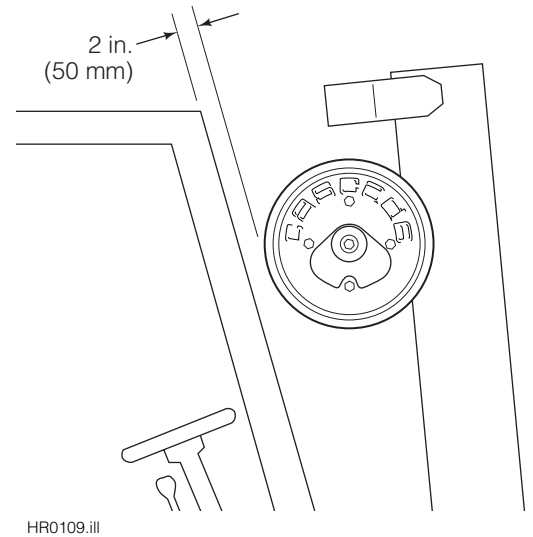
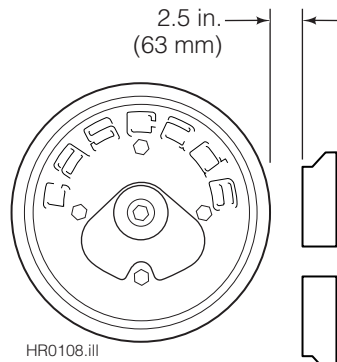
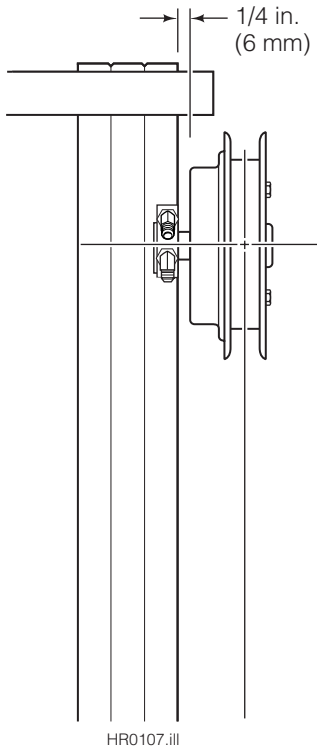
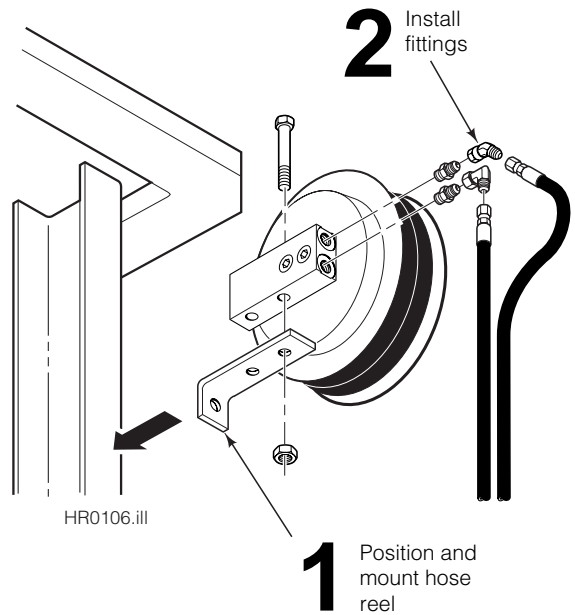

Minimum Clearances

- 3 Raise the carriage to position the upper carriage bar just below the hose reel. Align the carriage block with the centerline of the reel. Weld the block to the upper carriage bar.

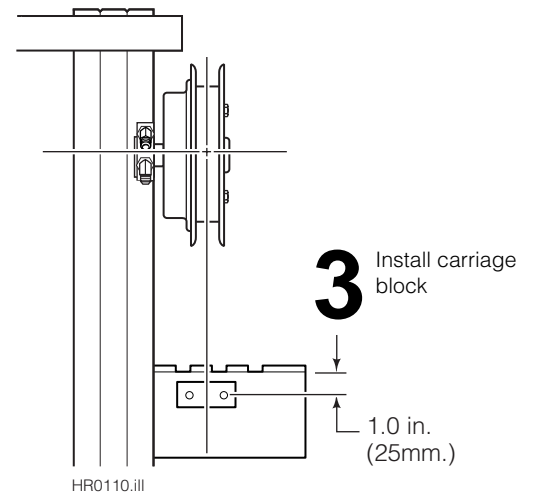

4 Install the hose end into the restraint.

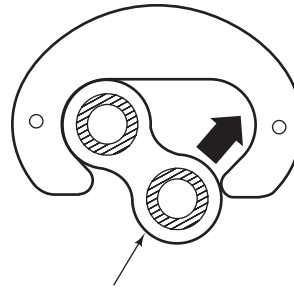

4 Install hose into restraint

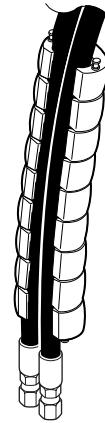

HR0100.iii

5 Install fittings and hose ends to the hose reel hub. Wind the hose onto the hose reel.

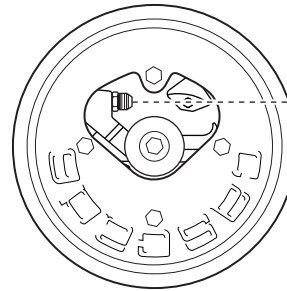

5 Install fittings and hoses

HR0101.iii

6 With the hose reel mounted on the mast, prewind the hose reel 5 revolutions clockwise (maximum reel turns are 13).

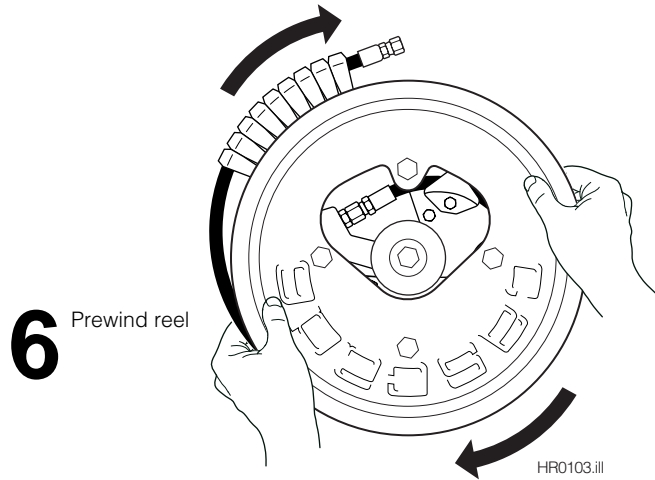

6 Prewind reel

HR0103.iii

7 Install the hose end restraint to the carriage block using the clamp. Position the clamp locating tab between the first and second restraint segments. Tighten the capscrews to a torque of 16 ft.-lbs. (22 Nm).

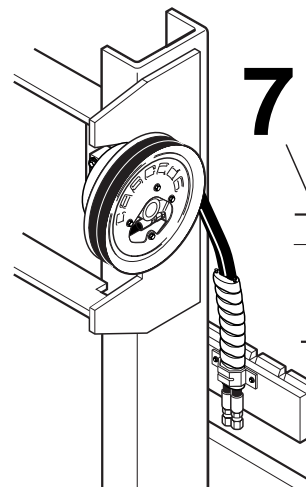

7 Install hose end restraint

Locating Tab

HR0104.iii

- 8 Install the No. 6 hoses from the bottom of the valve to the hose reel body fittings.

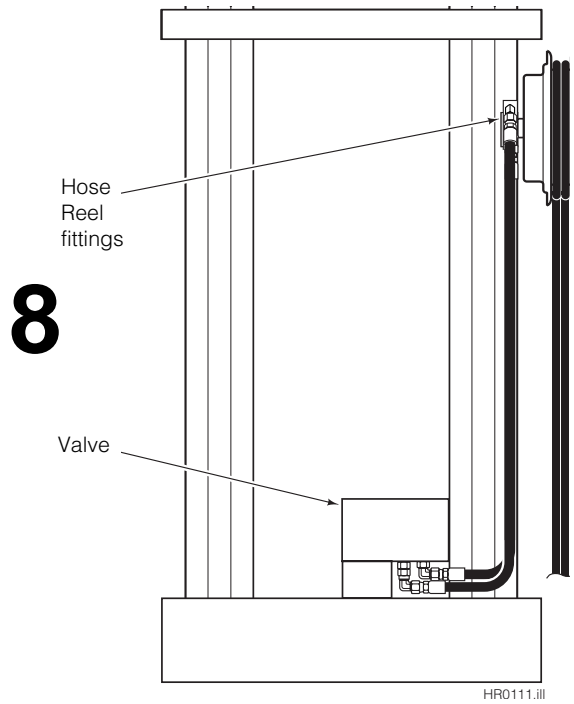

- 9 Raise and lower the mast carriage slowly, checking clearances. Tilt the mast forward and backward.

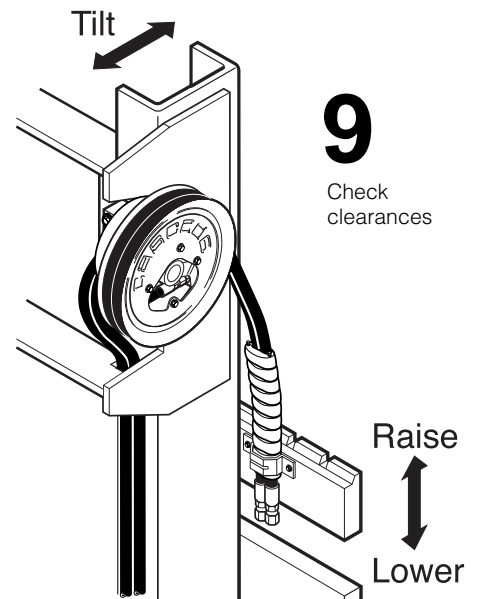

Control Kit Installation

- 1 Disconnect the cable from the positive battery terminal.

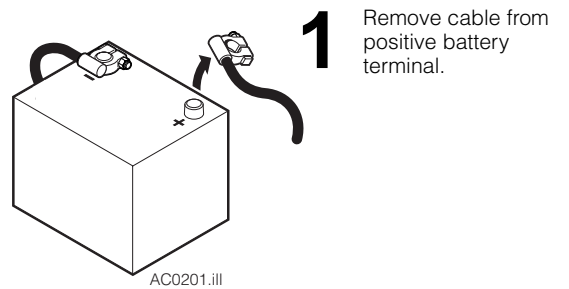

- 2 Install the switch to the control handle. Remove the control knob. Position the switch on the handle in a location for comfortable thumb or index finger operation. Place the double sided tape under the switch to secure the switch in place.

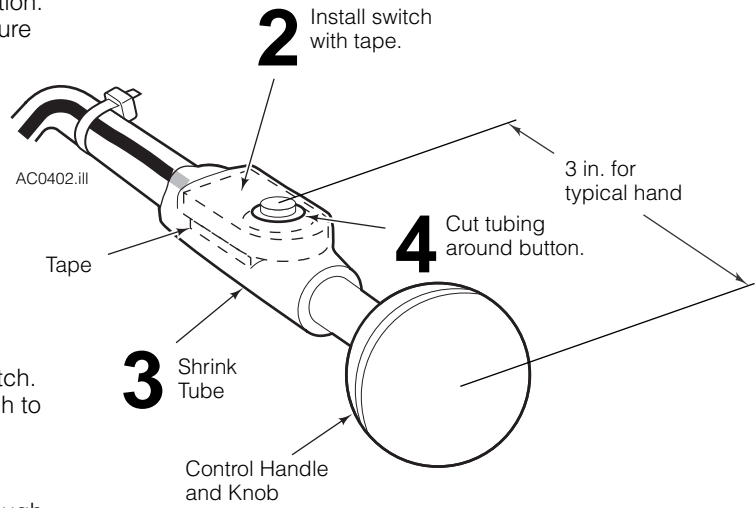

- 3 Place the heat shrink tubing over the handle and switch. Using a heat gun, heat the tubing to secure the switch to the handle. Reinstall the knob. Install cable ties as needed for the wire.
- 4 If it is difficult to feel or operate the switch button through the heat shrink tube, carefully cut a circle out of the tubing around the button.

- 5 Connect the wire harness to the solenoid cable connector and truck power as marked. Watch for pinch and wear points. Install cable ties as needed.
- 6 Connect the control handle switch connector to the wire harness connector. Watch for pinch and wear points. Install cable ties as needed.
- 7 Connect the battery cable to the positive battery terminal.
- 8 Test the electrical functions for proper operation.

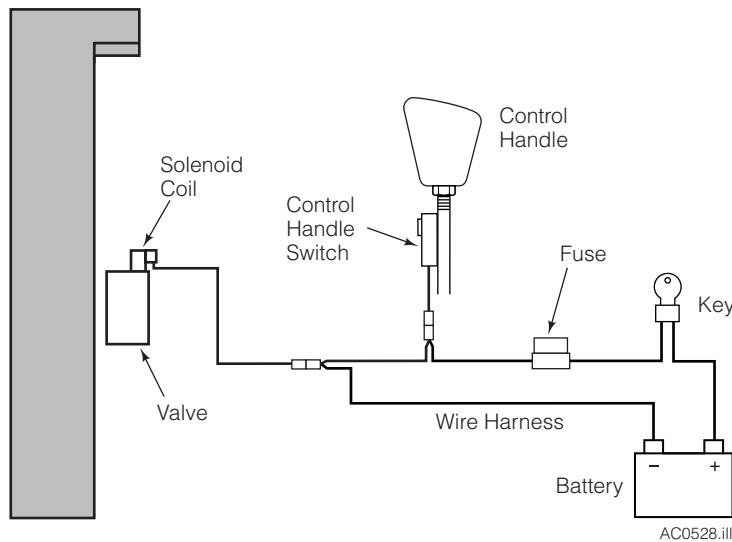
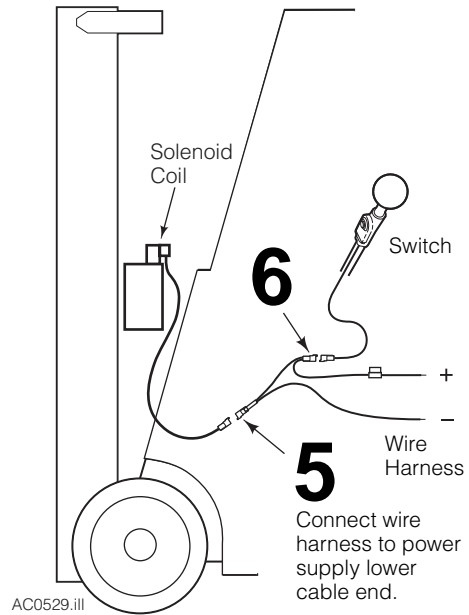

Hydraulic Functions

Connect the attachment functions to the supply hose fittings as shown.

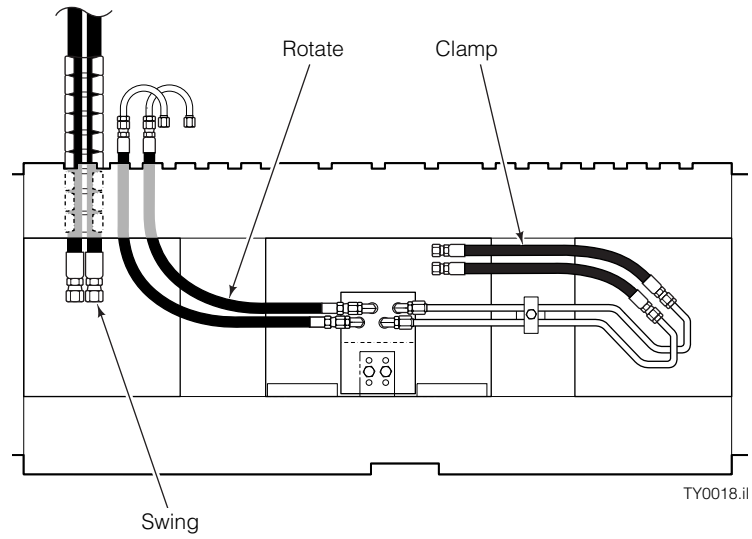

Do you have questions you need answered right now? Call your nearest Cascade Service Department.

**Cascade Corporation
U.S. Headquarters**
2201 NE 201st
Fairview, OR 97024-9718
Tel: 800-CASCADE (227-2233)
FAX: 888-329-8207

Cascade Canada Inc.
5570 Timberlea Blvd.
Mississauga, Ontario
Canada L4W-4M6
Tel: 905-629-7777
FAX: 905-629-7785

Cascade GmbH
D-41199 Monchengladbach
Klosterhofweg 52
Germany
Tel: 21-66-602091
FAX: 21-66-680947

Cascade Finland
01370 Vantas
Finland
Tel: 358-0-836-1925
FAX: 358-0-836-1935

**Cascade N.V.
European Headquarters**
P.O. Box 3009
1300 El Almere
Damsluisweg 56
1332 ED Almere
The Netherlands
Tel: 31-36-5492911
FAX: 31-36-5492964

**Cascade N.V.
Benelux Sales and Service**
P.O. Box 3009
1300 El Almere
Damsluisweg 56
1332 ED Almere
The Netherlands
Tel: 31-36-5492950
FAX: 31-36-5492974

Cascade (UK) Ltd.
15, Orgreave Crescent
Dore House Industrial Estate
Handsworth
Sheffield S13 9NQ
England
Tel: 742-697524
FAX: 742-695121

**Cascade Scandinavia
Hydraulik A.B.**
Muskötgatan 19, E8-9
S25466 Helsingborg
Sweden
Tel: 42-151135
FAX: 42-152997

Cascade Norway
Østerliveien 37A
1153 Oslo
Norway
Tel: 47-22-743160
FAX: 47-22-743157

Cascade France S.A.R.L.
11, Rue Jean Charcot
Zone Industrielle Sud or
B.P. 22
91421 Morangis Cedex
France
Tel: 1- 64547501
FAX: 1-9790584

Cascade Hispania S.A.
Avenida De La Fabregada, 7
Hospitalet De Llobregat
Barcelona
Spain
Tel: 3-335-5158
FAX: 3-335-4756

Cascade Japan Ltd.
5-5-41,
Torikai Kami
Settsu, Osaka
Japan, 566
Tel: 81-726-53-3490
FAX: 81-726-53-3497

Cascade Korea
Room 508, Pum Yang Bldg.
750-14, Bang Bac-Dong
Se-Cho Ku, Seoul
Korea
Tel: 2599-7131 ext. 512
FAX: 2533-8089

HYCO-Cascade Pty. Ltd.
87 Antimony Street
Carole Park,
Brisbane 4300
Australia
Tel: 7-271-1966
FAX: 7-271-3830

HYCO-Cascade (NZ) Ltd.
15 Ra Ora Drive, East Tamaki
P.O. Box 38-440
Howick, Auckland
New Zealand
Tel: 9-273-9136
FAX: 9-273-9137

Cascade (Africa) Pty. Ltd.
P.O. Box 625, Isando 1600
60A Steel Road
Sparton, Kempton Park
South Africa
Tel: 975-9240
FAX: 394-1147

Cascade-Xiamen
Wanshan No. 1 Workshop
Huli Road
Xiamen 361006
Fujian, PRC
Tel: 592-562-4600
FAX: 592-562-4671

**Cascade (Singapore)
Trading Co.**
Four Seasons Park
Autumn Block - Apt. 1802
12 Cascaden Walk
Singapore
Tel: 65-834-1935
FAX: 65-834-1936