



# Installation Instructions

## Scenario 1 – Push/Pull and Sideshifter Conversion Kit 6029427

These instructions describe how to perform a Scenario 1 conversion to a Cascade 45E Push/Pull mounted on a 55F Sideshifter.

The Push/Pull conversion consists of new quick-disconnect lower hooks.

The Sideshifter conversion consists of a new cylinder, bronze lower hooks, bronze upper bearings and cylinder retaining roll pins.

### Push/Pull Conversion

- 1 Fully extend the faceplate. Lower the attachment onto a pallet.
- 2 Remove the lower mounting hooks.



**WARNING:** Before removing any hoses, relieve pressure in the hydraulic system. Turn the truck off, then open the truck auxiliary valve(s) several times in both directions.

- 3 Disconnect, tag and plug the hoses at the carriage hose terminals.
- 4 Lower the truck carriage and back away from the attachment.
- 5 Install the quick-disconnect lower hook guides to the lower mounting hook holes with the 5/8 in. offset to the top. Tighten the capscrews to a torque of 118-125 ft.-lbs. Install the lower hooks and insert the retainer pin in the lower hole.
- 6 When the push/pull is installed on the sideshifter, check the lower hook clearance. If clearance is excessive, reverse the guides.

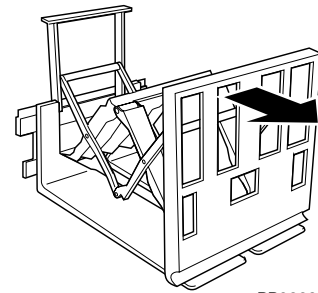
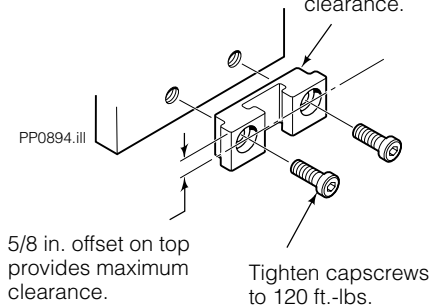
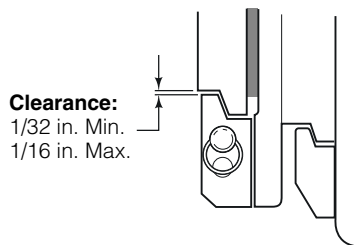

1 Extend faceplate

PP0889.ill

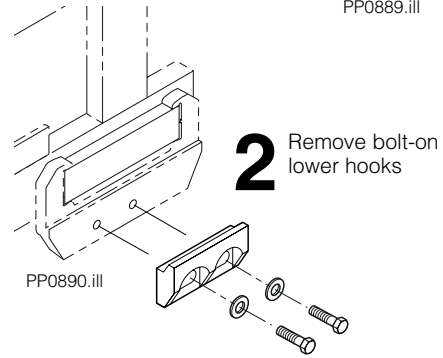

2 Remove bolt-on lower hooks

PP0890.ill

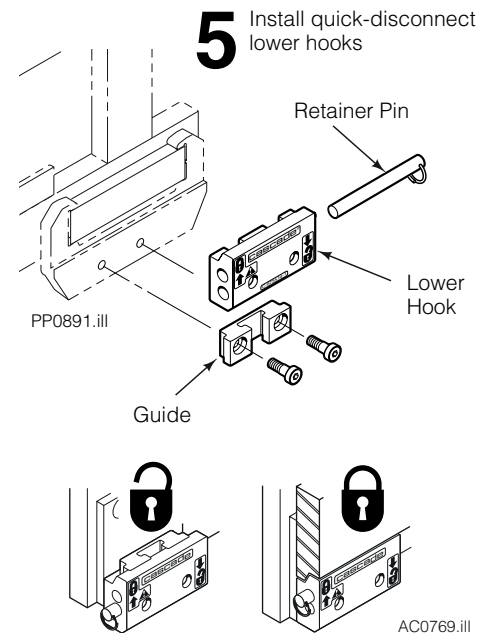

5 Install quick-disconnect lower hooks

PP0891.ill

Part No. 6029769-R1

**cascade**<sup>®</sup>  
**corporation**

#### For Technical Support . . .

Call: 1-800-227-2233 Fax: 1-888-329-8207  
Internet: [www.cascorp.com](http://www.cascorp.com)  
Write: Cascade Corporation, PO Box 20187, Portland, OR 97294

#### To Order Parts . . .

Call: 1-888-227-2233 Fax: 1-888-329-0234  
Internet: [www.cascorp.com](http://www.cascorp.com)  
Write: Cascade Corporation, 2501 Sheridan Ave., Springfield, OH 45505

## Sideshifter Conversion

- 1 Remove and discard the lower mounting hooks.



**WARNING:** Before removing any hoses, relieve pressure in the hydraulic system. Turn the truck off, then open the truck auxiliary valve(s) several times in both directions.

- 2 Disconnect, tag and plug the hoses at the sideshift cylinder.
- 3 Attach a 1000 lb. capacity overhead hoist to the sideshifter. Remove the sideshifter from the truck carriage and place on a pallet.
- 4 Remove the cylinder retainer pins. Remove the cylinder/anchor bracket assembly from the frame.

- 4 Remove retaining pins and cylinder.

- 6 Install new cylinder

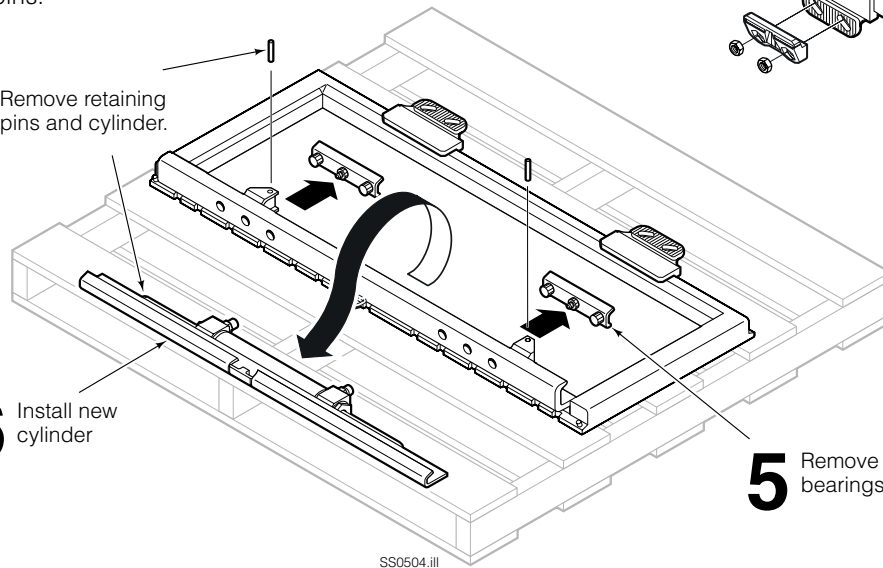

SS0505.iii

- 5 Remove the upper bearings by driving them out of the frame. Install the new bronze bearings.

**IMPORTANT:** Use a wood block or plastic hammer to fully seat the new bearings into the upper frame (see illustration). Proper lower hook clearance requires that upper bearings be fully seated into upper frame.

- 6 Install the new cylinder/anchor bracket assembly and cylinder retainer pins.

- 7 Install the new bronze lower hooks to the frame.

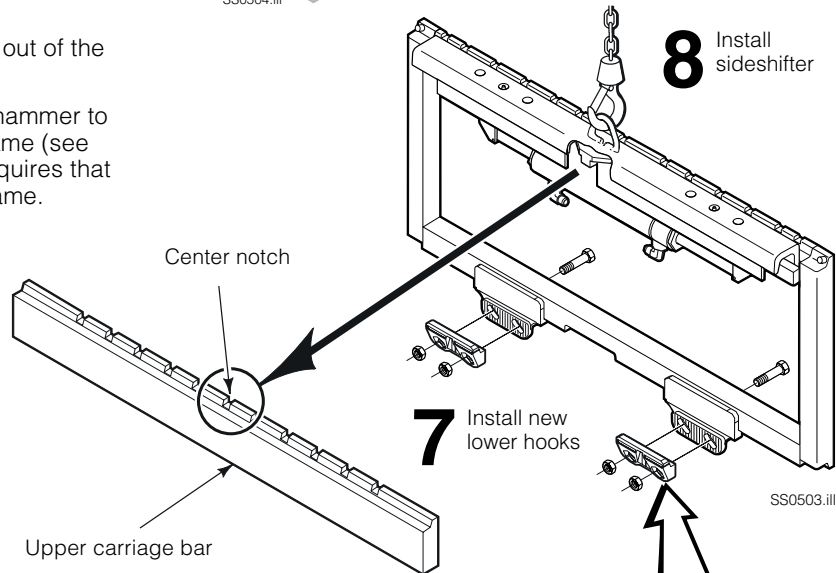

SS0503.iii

- 8 Install the sideshifter on the truck carriage. Engage the locator tab with the upper carriage bar center notch.

- 9 Adjust the lower hooks clearance. Tighten the lower hook capscrews to a torque of 120 ft.-lbs.

- 9 Adjust lower hooks

**Clearance:**  
1/32 in. Min.  
1/16 in. Max.

120 ft.-lbs.

SS0502.iii