



# Installation Instructions

## Drop Stop Valve Kit 6044220

This sheet provides installation instructions and replacement parts list for the Cascade Drop Stop Valve. The valve eliminates slack in the mast lift chains and subsequent drop of the carriage and clamp or forks when the load is released. This is caused by holding the lowering control valve open after the load has been deposited.

**IMPORTANT: The valve is only effective in hoist free-lift operation on a Full Free-lift Mast. The valve is effective through the entire hoist range on Limited Free-lift Masts.**

- 1 Determine a valve mounting location on the truck cowl, under the floorboard or on the mast. The valve must clear the mast when fully tilted back.
- 2 Mount the valve using 3/8 in. (9 mm) dia. capscrews (user supplied). **Position the valve vent hole downward.**
- 3 Make two No. 12 hoses to connect the valve between the hoist control valve and mast lowering control valve. Install the hoses and fittings.
- 4 If an accumulator will be installed in the circuit, install it between the hoist control valve and drop stop valve.

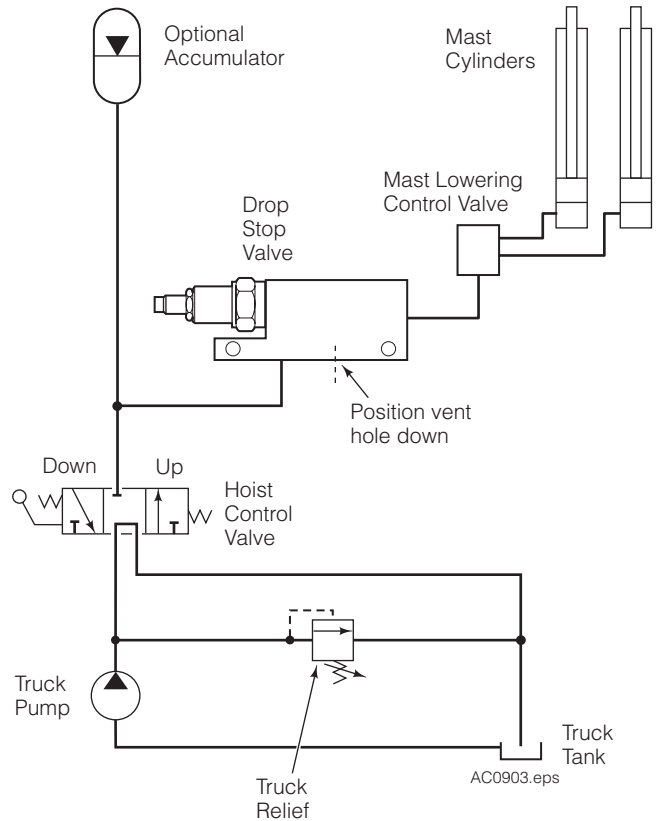
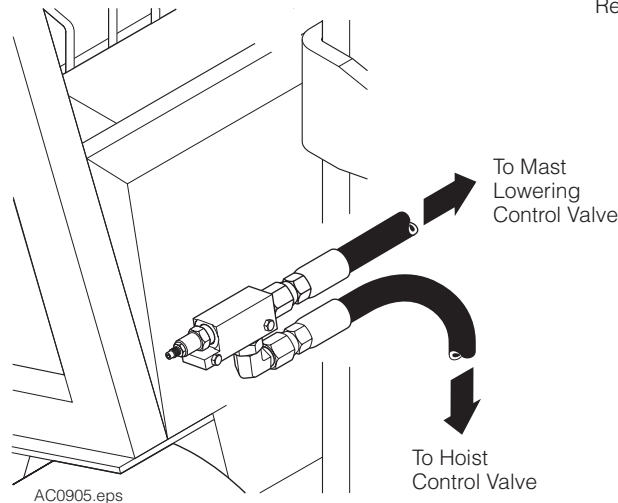
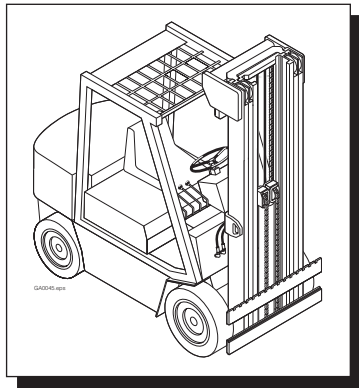

Part No. 6041342-R4

**cascade**<sup>®</sup>  
**corporation**

**For Technical Support . . .**

Call: 1-800-227-2233 Fax: 1-888-329-8207  
 Internet: [www.cascorp.com](http://www.cascorp.com)  
 Write: Cascade Corporation, PO Box 20187, Portland, OR 97294

**To Order Parts . . .**

Call: 1-888-227-2233 Fax: 1-888-329-0234  
 Internet: [www.cascorp.com](http://www.cascorp.com)  
 Write: Cascade Corporation, 2501 Sheridan Ave., Springfield, OH 45505

## Valve Adjustment

- 1 Loosen the jam nut (3/4 in. hex) on the valve cartridge. Use a 1/4 in. Allen wrench to turn the adjustment screw CCW until internal spring tension is released.
- 2 Cycle the mast several times to remove air in supply line.
- 3 Raise the mast carriage 3 ft. (90 cm) off the floor, then lower to the floor. Turn the cartridge adjustment screw CW 1/2 turn.
- 4 Repeat step 3 until the carriage lowering speed starts to slow. This will be the maximum setting.

**IMPORTANT: The valve is only effective in hoist free-lift operation on a Full Free-lift Mast. The valve is effective through the entire hoist range on Limited Free-lift Masts.**

## Valve Operation

After setting the maximum setting:

- 1 Raise the truck carriage approximately 1 ft. (30 cm) and block under the carriage or attachment. Lower onto the block.
- 2 Actuate the truck hoist lever in the lowering position for 5 seconds.

The Drop Stop Valve is functioning correctly if the hoist chains are tight when the carriage or attachment is lowered onto the block and the hoist lowering lever is activated.

- If the chains are slack, turn the cartridge adjustment screw 1/2 turn CW and retest until the chains are tight.

- 3 Tighten the cartridge jam nut.

**NOTE:** During service operation, the valve is operating correctly if once unclamped from a load or backing out of fork pockets you will have minimal attachment movement, thus limiting damage to the product or packaging

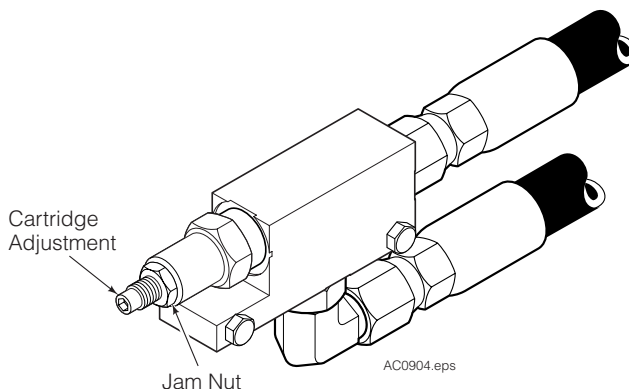

## Drop Stop Valve Assembly

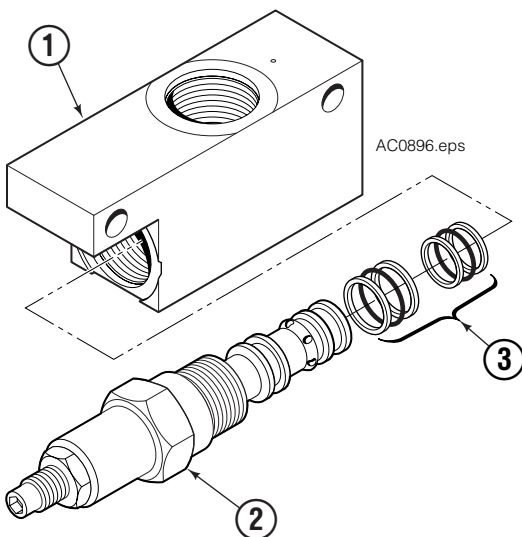

REF	QTY	PART NO.	DESCRIPTION
		6044220	Valve Assembly Kit
		6035205	Valve
1	1	6035204	Valve Body
2	1	6035203	Cartridge
3	1	6041329	Cartridge Seal Kit