



Technical Bulletin

Number 129

October 1983

ITA Class II Mounting

ITA Class II mounting installation

Models: 60D Carton Clamps and similar AED attachments

1. Install the upper mounting hooks. The upper hook with the tab must be installed on the left side of the attachment (as viewed from the drivers seat). Tighten the capscrews to a torque of 90-100 ft.-lbs.

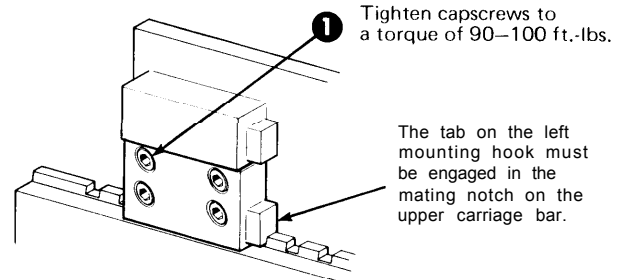

2. **QUICK DISCONNECT LOWER HOOKS** Install the lower hook assemblies as shown. Pull out the retaining pins and rotate the hooks down to the position shown.

STANDARD LOWER HOOKS Do not install lower hooks until step 5.

3. Attach a suitable overhead chain hoist to the attachment. Position the attachment as shown.
4. Center the lift truck behind the attachment. Tilt the mast forward. Engage the mounting hook tab with the closest upper carriage bar notch and raise the truck carriage into position on the attachment. Lift the attachment 1 or 2 inches off the pallet.

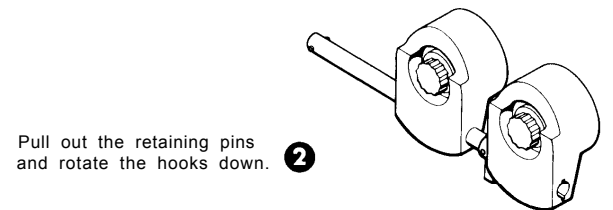
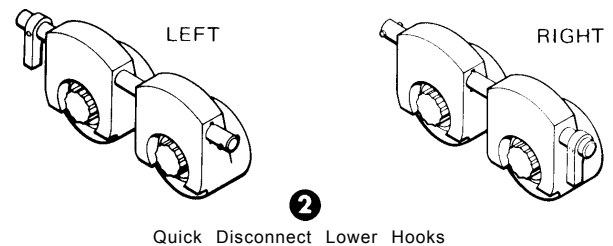

NOTE: The attachment may not be perfectly centered on the carriage bar when the mounting hook tab is engaged in the carriage notch.

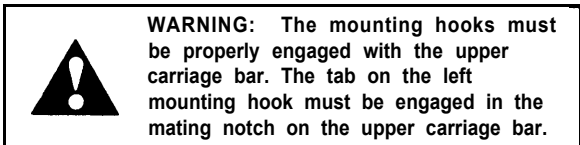

NOTE: The lower hooks cannot be properly installed if the upper hook tab is not engaged in the carriage notch.

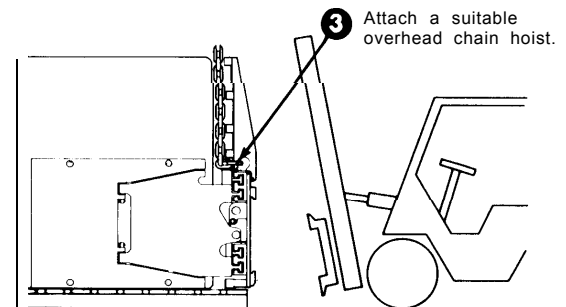

(OVER)

cascade[®] corporation

P.O. Box 20187 • Portland, Oregon 97220 • (503) 666-1511
P.O. Box 360 • Springfield, Ohio 45505 • (513) 335-93271

Do you have questions
you need answered
right now?

Dial Directline
800-227-2233
(toll free)

5. **QUICK DISCONNECT LOWER HOOKS** - Turn the lower mounting hooks up and reinstall the pin as shown. Retighten the bolts to a torque of 105-115 ft.-lbs. The maximum allowable clearance between the hooks and carriage bar is 1/8 inch as shown.

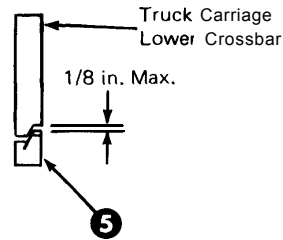

Turn the lower mounting hooks up

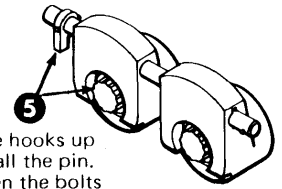

Turn the hooks up and install the pin. Retighten the bolts to a torque of 105-115 ft.-lbs.

STANDARD LOWER HOOKS - Install the lower mounting hooks. Tighten the capscrews finger tight. Tap the end of the mounting hooks with a hammer in the direction of the adjust arrow for maximum engagement with the lower carriage bar. Tighten the capscrews to a torque of 105-115 ft.-lbs.

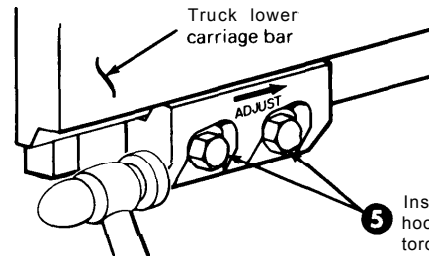

Install lower mounting hooks and tighten to torque values shown.