



Bring palletless handling to your operation.

*Built for fast,
efficient and
productive clamp
handling.*

APPLICATIONS

Achieve all the benefits of palletless handling of unitized loads in your manufacturing and distribution operation. Cascade's D-Series Carton Clamps allow efficient handling of a wide range of low-, medium- and high-density products including consumer paper products, appliances, consumer electronics, wine, packaged foods (canned or boxed), chemicals and plastics.

FEATURES

- Proven arm and aluminum frame construction ensures long useful life of the clamp.
- Unique pivoting arm and stabilizer design allows superior clamping force distribution for secure and damage free handling of a wide range of product types.
- Thin arm profiles allow for stacking loads tightly in the warehouse.
- Superior arm-slide bearing material and design extends bearing life and maintains balanced clamp force distribution.
- Rubber faced aluminum contact pads are standard and provide a high coefficient of friction to securely hold loads.
- Regenerative hydraulic valving is standard for optimal arm speed.

OPTIONS

- Application specific contact pads (sizes & surfaces)
- Quick Disconnect mounting
- Custom opening ranges
- Tilt Control
- Load Cushion



15 & 25D CARTON CLAMPS

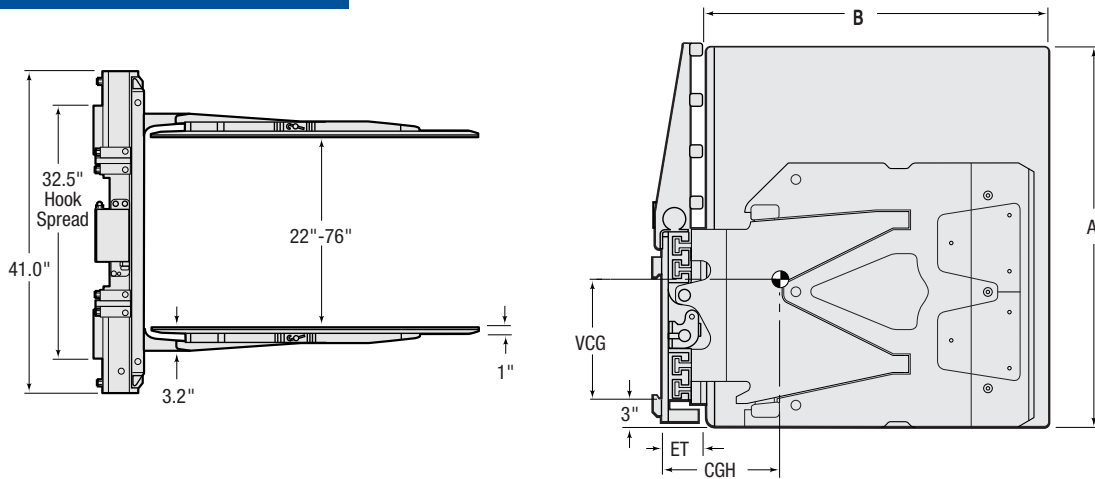

Sideshifting

Capacity @ Load Center		Opening Range	Catalog Order No. Bolt-On Lower Hooks	Mounting Class	Weight		Effective Thickness ET	Horizontal Center of Gravity HCG	Vertical Center of Gravity VCG	Arm Height A	Arm Length B
lbs @ inches	kg @ mm				lbs.	kg					
1,500 @ 15"	680 @ 380	22"-76"	15D-CCS-01A	II	1,255	570	5.0"	15.3"	13.6"	48"	30"
1,500 @ 15"	680 @ 405	22"-76"	15D-CCS-28A	II	1,295	588	5.0"	13.6"	13.7"	48"	32"
1,500 @ 20"	680 @ 510	22"-76"	15D-CCS-32A	II	1,400	636	5.0"	17.0"	12.8"	48"	40"
1,500 @ 21"	680 @ 535	22"-76"	15D-CCS-33A	II	1,415	642	5.0"	17.1"	12.8"	48"	42"
1,500 @ 23"	680 @ 585	22"-76"	15D-CCS-34A	II	1,515	688	5.0"	17.2"	12.6"	48"	46"
1,500 @ 24"	680 @ 600	22"-76"	15D-CCS-35A	II	1,535	697	5.0"	17.3"	12.6"	48"	48"
2,500 @ 15"	1,135 @ 380	22"-76"	25D-CCS-01A	II	1,255	570	5.0"	15.3"	13.6"	48"	30"
2,500 @ 20"	1,135 @ 510	22"-76"	25D-CCS-32A	II	1,400	636	5.0"	17.0"	12.8"	48"	40"
2,500 @ 21"	1,135 @ 535	22"-76"	25D-CCS-33A	II	1,415	642	5.0"	17.1"	12.8"	48"	42"
2,500 @ 23"	1,135 @ 585	22"-76"	25D-CCS-34A	II	1,515	688	5.0"	17.2"	12.6"	48"	46"
2,500 @ 24"	1,135 @ 600	22"-76"	25D-CCS-35A	II	1,535	697	5.0"	17.3"	12.6"	48"	48"

- ▶ Class II Bolt-On mounting is standard. Class III and Quick-Disconnect mounting also available.
- ▶ Front lower leading edge pad wear can be addressed by periodic replacement of the factory installed wear tiles. Contact Cascade Parts Department at 888-CASCADE (227-2233) for service kits. Cascade recommends using tilt control with all carton clamps.
- ▶ Can easily be converted to non-sideshifting by plugging ports on the valve.
- ▶ Attachment capacity should be matched to truck rating for most efficient application.
- ▶ Additional contact pad sizes, arm opening ranges, and features are available. Contact Cascade.
- ▶ All Carton Clamps are sideshifting.

INSTALLATION KIT

Model	Catalog Order No.
15D/25D	659249

HYDRAULIC FLOW AND PRESSURE

Model	Minimum Flow	Recommended Flow	Maximum Flow	Maximum Pressure
15D	5 GPM	5.5 GPM	8 GPM	2,300 PSI/159 bar
25D	5 GPM	5.5 GPM	8 GPM	2,300 PSI/159 bar

MOUNTING CLASS INFORMATION

Mounting Class	Truck Capacity
II	2,000-5,500 lbs.
III	6,000-10,000 lbs

HYDRAULIC FUNCTIONS

Model	Hydraulic Functions	Truck Auxiliary Valves Required
15D/25D	2	2

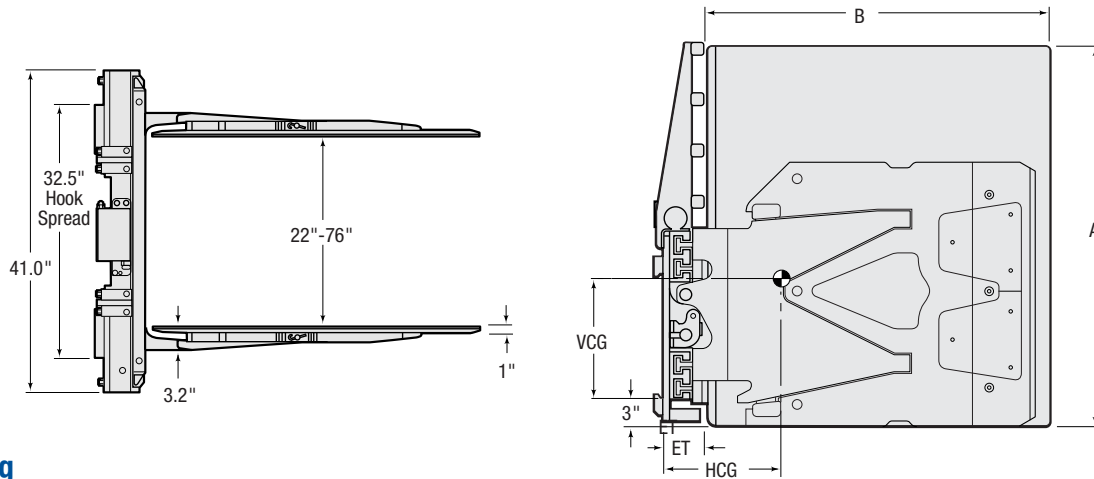

Sideshifting

Capacity @ Load Center		Opening Range	Catalog Order No. Bolt-On Lower Hooks	Mounting Class	Weight		Effective Thickness ET	Horizontal Center of Gravity HCG	Vertical Center of Gravity VCG	Arm Height A	Arm Length B
lbs. @ inches	kg @ mm				lbs.	kg					
3,500 @ 20"	1,590 @ 510	22"-76"	35D-CCS-32A	II	1,420	645	5.0"	16.6"	12.8"	48"	40"
3,500 @ 21"	1,590 @ 535	22"-76"	35D-CCS-33A	II	1,435	652	5.0"	16.8"	12.8"	48"	42"
3,500 @ 23"	1,590 @ 585	22"-76"	35D-CCS-34A	II	1,535	697	5.0"	17.6"	12.4"	48"	46"
3,500 @ 24"	1,590 @ 600	22"-76"	35D-CCS-35A	II	1,555	706	5.0"	17.7"	12.6"	48"	48"
3,300 @ 26"	1,500 @ 660	22"-76"	35D-CCS-36A	II	1,660	754	5.0"	18.6"	12.4"	48"	52"
3,200 @ 27"	1,455 @ 685	22"-76"	35D-CCS-37A	II	1,675	761	5.0"	18.7"	12.4"	48"	54"
3,500 @ 20"	1,590 @ 510	22"-76"	35D-CCS-42A	II	1,485	674	5.0"	16.9"	14.0"	54"	40"
3,500 @ 21"	1,590 @ 535	22"-76"	35D-CCS-43A	II	1,500	681	5.0"	17.0"	13.9"	54"	42"
3,500 @ 23"	1,590 @ 585	22"-76"	35D-CCS-44A	II	1,605	729	5.0"	17.9"	13.8"	54"	46"
3,500 @ 24"	1,590 @ 600	22"-76"	35D-CCS-45A	II	1,620	736	5.0"	18.0"	13.8"	54"	48"
3,300 @ 26"	1,500 @ 660	22"-76"	35D-CCS-46A	II	1,730	785	5.0"	18.8"	13.7"	54"	52"
3,200 @ 27"	1,455 @ 685	22"-76"	35D-CCS-47A	II	1,745	792	5.0"	18.9"	13.7"	54"	54"
3,500 @ 20"	1,590 @ 510	22"-76"	35D-CCS-92A	II	1,550	704	5.0"	17.1"	15.3"	60"	40"
3,500 @ 21"	1,590 @ 535	22"-76"	35D-CCS-93A	II	1,565	711	5.0"	17.2"	15.3"	60"	42"
3,500 @ 23"	1,590 @ 585	22"-76"	35D-CCS-94A	II	1,670	758	5.0"	18.1"	15.1"	60"	46"
3,500 @ 24"	1,590 @ 600	22"-76"	35D-CCS-95A	II	1,690	767	5.0"	18.2"	15.1"	60"	48"
3,300 @ 26"	1,500 @ 660	22"-76"	35D-CCS-96A	II	1,795	815	5.0"	19.1"	15.0"	60"	52"
3,200 @ 27"	1,455 @ 685	22"-76"	35D-CCS-97A	II	1,815	824	5.0"	19.2"	15.0"	60"	54"

- ▶ Class II Bolt-On mounting is standard. Class III and Quick-Disconnect mounting also available.
- ▶ Front lower leading edge pad wear can be addressed by periodic replacement of the factory installed wear tiles. Contact Cascade Parts Department at 888-CASCADE (227-2233) for service kits. Cascade recommends using tilt control with all carton clamps. See page 6-3.
- ▶ Can easily be converted to non-sideshifting by plugging ports on the valve.
- ▶ Attachment capacity should be matched to truck rating for most efficient application.
- ▶ Additional contact pad sizes, arm opening ranges, and features are available. Contact Cascade.
- ▶ All Carton Clamps are sideshifting.

INSTALLATION KIT

Model	Catalog Order No.
35D	659249

HYDRAULIC FLOW AND PRESSURE

Model	Minimum Flow	Recommended Flow	Maximum Flow	Maximum Pressure
35D	5 GPM	7 GPM	10 GPM	2,300 PSI/159 bar

MOUNTING CLASS INFORMATION

Mounting Class	Truck Capacity
II	2,000-5,500 lbs.
III	6,000-10,000 lbs

HYDRAULIC FUNCTIONS

Model	Hydraulic Functions	Truck Auxiliary Valves Required
35D	2	2

50D CARTON CLAMP

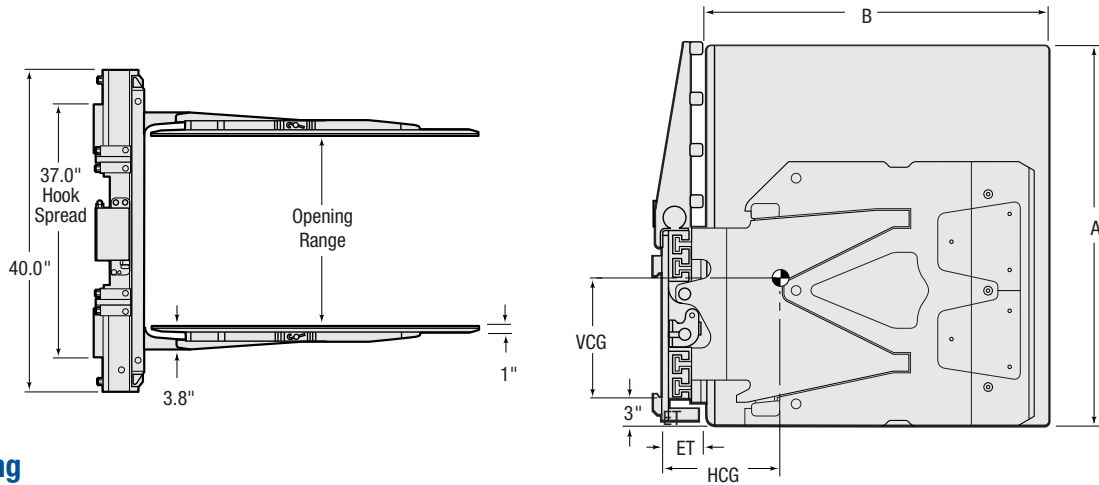

Sideshifting

Capacity @ Load Center		Opening Range	Catalog Order No. Bolt-On Lower Hooks	Mounting Class	Weight		Effective Thickness ET	Horizontal Center of Gravity HCG	Vertical Center of Gravity VCG	Arm Height A	Arm Length B
lbs. @ inches	kg @ mm				lbs.	kg					
5,000 @ 20"	2,270 @ 510	21"-73"	50D-CCS-21B	III	1,980	899	6.0"	19.1"	17.8"	60"	40"
5,000 @ 21"	2,270 @ 535	21"-73"	50D-CCS-22B	III	1,995	906	6.0"	19.2"	17.8"	60"	42"
5,000 @ 22"	2,270 @ 560	21"-73"	50D-CCS-23B	III	2,005	910	6.0"	19.3"	17.8"	60"	44"
5,000 @ 23"	2,270 @ 585	21"-73"	50D-CCS-24B	III	2,095	951	6.0"	20.2"	16.8"	60"	46"
5,000 @ 24"	2,270 @ 600	21"-73"	50D-CCS-25B	III	2,110	958	6.0"	20.3"	16.9"	60"	48"

- ▶ Class III Bolt-On mounting is standard. Class II and IV and Quick-Disconnect mounting also available.
- ▶ Front lower leading edge pad wear can be addressed by periodic replacement of the factory installed wear tiles. Contact Cascade Parts Department at 888-CASCADE (227-2233) for service kits. Cascade recommends using tilt control with all carton clamps. See page 6-3.
- ▶ Can easily be converted to non-sideshifting by plugging ports on the valve.
- ▶ Attachment capacity should be matched to truck rating for most efficient application.
- ▶ Additional contact pad sizes, arm opening ranges, and features are available. Contact Cascade.
- ▶ All Carton Clamps are sideshifting.

MOUNTING CLASS INFORMATION

Mounting Class	Truck Capacity
III	6,000-10,000 lbs
IV	10,001-17,500 lbs.

HYDRAULIC FUNCTIONS

Model	Hydraulic Functions	Truck Auxiliary Valves Required
50D	2	2

INSTALLATION KIT

Model	Catalog Order No.
50D	659249

HYDRAULIC FLOW AND PRESSURE

Model	Minimum Flow	Recommended Flow	Maximum Flow	Maximum Pressure
50D	5 GPM	12 GPM	15 GPM	2,300 PSI/159 bar